

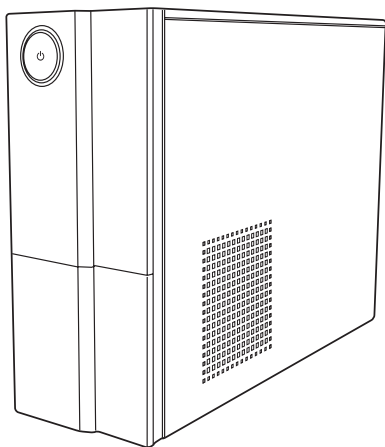

# **ASUS Essentio Desktop PC**

## **User Manual**



E4619

Second Edition V2  
March 2009

**Copyright © 2009 ASUSTeK COMPUTER INC. All Rights Reserved.**

No part of this manual, including the products and software described in it, may be reproduced, transmitted, transcribed, stored in a retrieval system, or translated into any language in any form or by any means, except documentation kept by the purchaser for backup purposes, without the express written permission of ASUSTeK COMPUTER, INC. ("ASUS").

Products and corporate names mentioned in this manual may or may not be registered trademarks or copyrights of their respective companies, and are used for identification purposes only. All trademarks are the property of their respective owners.

Every effort has been made to ensure that the contents of this manual are correct and up to date. However, the manufacturer makes no guarantee regarding the accuracy of its contents, and reserves the right to make changes without prior notice.

# Contents

- Notices .....4
- Safety information .....6
- Notes for this manual .....7
- Welcome ..... 8**
  - Package contents .....8
- Knowing your Desktop PC ..... 9**
  - Front / Rear panel features .....9
- Setting up your Desktop PC..... 11**
  - Connecting devices..... 11
  - Connecting the power ..... 12
  - Pressing the power button to turn on the system..... 12
- Recovering your system ..... 13**
  - Using the recovery DVD ..... 13
  - Quickly recover your system ..... 14
- Troubleshooting ..... 15**

# Notices

## ASUS REACH

Complying with the REACH (Registration, Evaluation, Authorisation, and Restriction of Chemicals) regulatory framework, we published the chemical substances in our products at ASUS REACH website at <http://green.asus.com/english/REACH.htm>

## Federal Communications Commission Statement

This device complies with Part 15 of the FCC Rules. Operation is subject to the following two conditions:

- This device may not cause harmful interference; and
- This device must accept any interference received including interference that may cause undesired operation.

This equipment has been tested and found to comply with the limits for a Class B digital device, pursuant to Part 15 of the FCC Rules. These limits are designed to provide reasonable protection against harmful interference in a residential installation. This equipment generates, uses and can radiate radio frequency energy and, if not installed and used in accordance with manufacturer's instructions, may cause harmful interference to radio communications. However, there is no guarantee that interference will not occur in a particular installation. If this equipment does cause harmful interference to radio or television reception, which can be determined by turning the equipment off and on, the user is encouraged to try to correct the interference by one or more of the following measures:

- Reorient or relocate the receiving antenna.
- Increase the separation between the equipment and receiver.
- Connect the equipment to an outlet on a circuit different from that to which the receiver is connected.
- Consult the dealer or an experienced radio/TV technician for help.



---

The use of shielded cables for connection of the monitor to the graphics card is required to assure compliance with FCC regulations. Changes or modifications to this unit not expressly approved by the party responsible for compliance could void the user's authority to operate this equipment.

---

## Canadian Department of Communications Statement

This digital apparatus does not exceed the Class B limits for radio noise emissions from digital apparatus set out in the Radio Interference Regulations of the Canadian Department of Communications.

This class B digital apparatus complies with Canadian ICES-003.

## Macrovision Corporation Product Notice

This product incorporates copyright protection technology that is protected by method claims of certain U.S. patents and other intellectual property rights owned by Macrovision Corporation and other rights owners. Use of this copyright protection technology must be authorized by Macrovision Corporation, and is intended for home and other limited viewing uses only **unless otherwise authorized by Macrovision Corporation**. Reverse engineering or disassembly is prohibited.

---

### *Lithium-Ion Battery Warning*

---

**CAUTION:** Danger of explosion if battery is incorrectly replaced. Replace only with the same or equivalent type recommended by the manufacturer. Dispose of used batteries according to the manufacturer's instructions.

**VORSICHT:** Explosionsgefahr bei unsachgemäßen Austausch der Batterie. Ersatz nur durch denselben oder einem vom Hersteller empfohlenem ähnlichen Typ. Entsorgung gebrauchter Batterien nach Angaben des Herstellers.

# Safety information

Your ASUS Desktop PC is designed and tested to meet the latest standards of safety for information technology equipment.

However, to ensure your safety, it is important that you read the following safety instructions.

## Setting up your system

- Read and follow all instructions in the documentation before you operate your system.
- Do not use this product near water or a heated source such as a radiator.
- Set up the system on a stable surface.
- Openings on the chassis are for ventilation. Do not block or cover these openings. Make sure you leave plenty of space around the system for ventilation. Never insert objects of any kind into the ventilation openings.
- Use this product in environments with ambient temperatures between 0°C and 35°C.
- If you use an extension cord, make sure that the total ampere rating of the devices plugged into the extension cord does not exceed its ampere rating.

## Care during use

- Do not walk on the power cord or allow anything to rest on it.
- Do not spill water or any other liquids on your system.
- When the system is turned off, a small amount of electrical current still flows. Always unplug all power, modem, and network cables from the power outlets before cleaning the system.
- If you encounter the following technical problems with the product, unplug the power cord and contact a qualified service technician or your retailer.
  - The power cord or plug is damaged.
  - Liquid has been spilled into the system.

- The system does not function properly even if you follow the operating instructions.
- The system was dropped or the cabinet is damaged.
- The system performance changes.

## LASER PRODUCT WARNING

### CLASS 1 LASER PRODUCT

## NO DISASSEMBLY

**The warranty does not apply to the products that have been disassembled by users**



This symbol of the crossed out wheeled bin indicates that the product (electrical, electronic equipment, and mercury-containing button cell battery) should not be placed in municipal waste. Check local regulations for disposal of electronic products.

## Notes for this manual

To make sure that you perform certain tasks properly, take note of the following symbols used throughout this manual.



**WARNING:** Vital information that you **MUST** follow to prevent injury to yourself.



**IMPORTANT:** Instructions that you **MUST** follow to complete a task.



**TIP:** Tips and useful information that help you complete a task.



**NOTE:** Additional information for special situations.

# Welcome

---

Congratulations on your purchase of the ASUS Desktop PC. The package contents of your new Desktop PC are listed below but may vary with models. ASUS reserves the right to replace components or accessories to provide optimum serviceability.

Contact your retailer if any item is damaged or missing.

## Package contents

- ASUS Desktop PC x1
- Keyboard x1
- Mouse x1
- Power cord x1
- Support DVD x1
- Recovery DVD x1
- Installation Guide x1
- Warranty card x1



---

Visit the ASUS website at <http://support.asus.com> for any updates.

---



# Knowing your Desktop PC



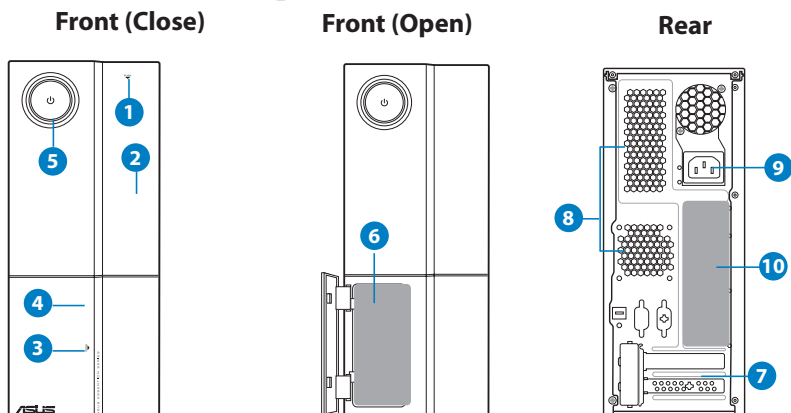









## Front / Rear panel features



\*The gray areas contain front/rear panel ports. These ports and their locations may vary, depending on the model of your system.

No.	Button/Port		Description
1.	▼		Optical drive reject button.
2.			Optical drive bay cover.
3.	↪		Push the front panel cover.
4.			Front panel cover.
5.	⏻		Power button
6.	USB 2.0	USB 2.0 ports	Connect to USB devices such as a mouse, keyboard, or camera.
	IEEE 1394	4-pin IEEE 1394a port	Connects to an IEEE 1394 device such as a digital camrecorder.
	Headphone	Headphone jack	Plug a stereo or headphones into this jack.
	Microphone	Microphone jack	Plug a microphone into this jack.

*continued on the next page*

No.	Slot/Port	Description
6.	 MMC, SD, MS, MS/PRO	Functions as a card reader for various types of memory cards.
7.	Expansion slots	Use the slots when installing expansion cards.
8.	Air vents	Allows ventilation
9.	Power connector	Connects power cable.
10.	 VGA port	Connects to a TV or monitor with different video output.
	 HDMI port	
	 LAN (RJ-45) port	Plug a network cable into this port.
	 COM port	Connects to devices that conforms with serial specification.
	 USB 2.0 ports	Connect to USB devices such as a mouse, keyboard, or camera.
	 6-pin IEEE 1394a port	Connects to an IEEE 1394 device such as a digital camrecorder.
	 Coaxial S/PDIF Out port	Connects to an amplifier for digital audio output.
	 PS/2 Keyboard port	Connects to a PS/2 keyboard.
	 PS/2 mouse port	Connects to a PS/2 mouse.
	 5.1(6)-channel audio ports  7.1(8)-channel audio ports	Connect to a 5.1(6) or 7.1(8)-channel speaker system.

# Setting up your Desktop PC

## Connecting devices

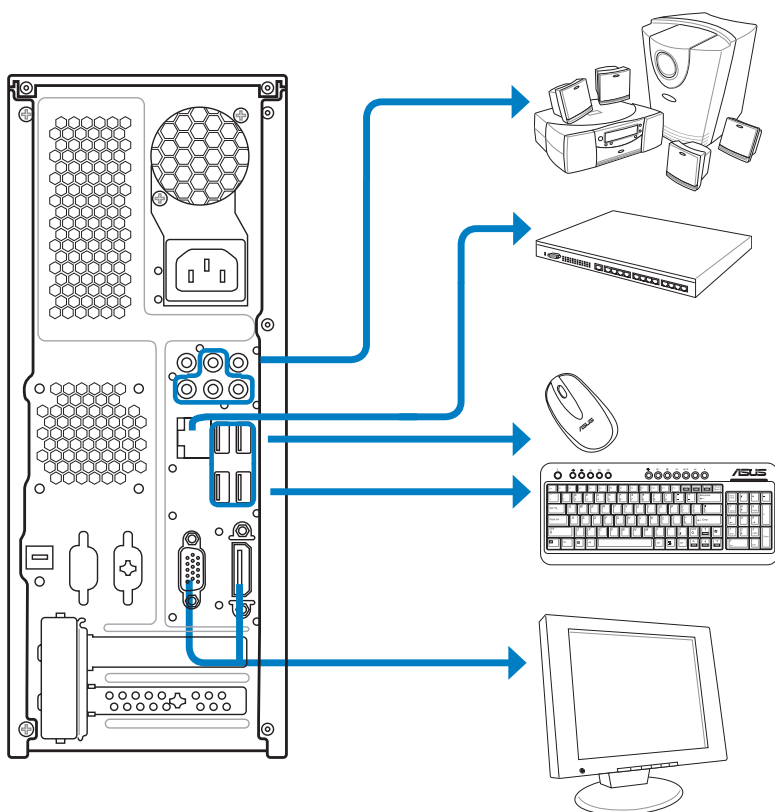

Illustrations are for reference only. Actual product specifications may vary.



- Use this product in ambient temperature below 35°C.
- Do not block or cover these vents.

## Connecting the power

1. Switch the Voltage selector to select the appropriate input voltage according to the voltage supply in your area.



Setting the voltage selector to 115V in a 230V area will damage your system!

2. Connect the power cord to the power connector and plug it into the wall socket.

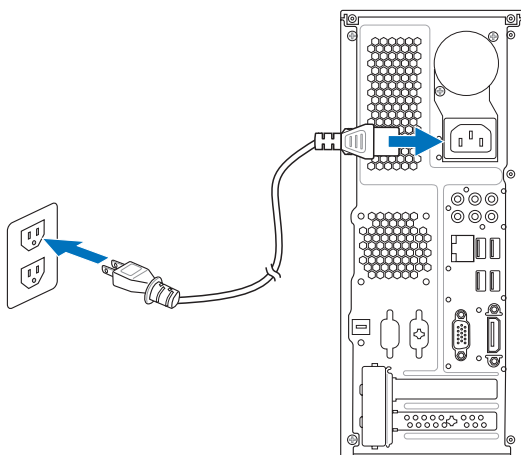

## Pressing the power button to turn on the system

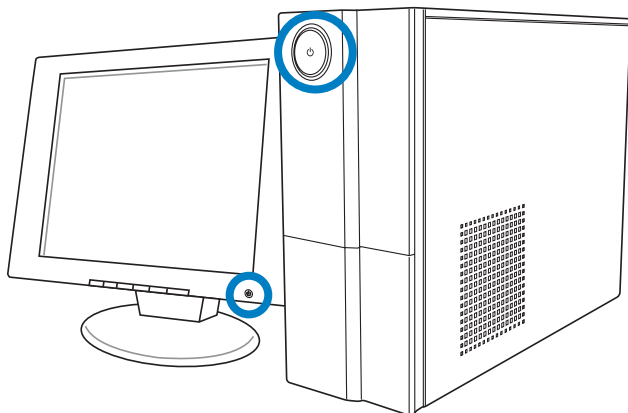

# Recovering your system

---

## Using the recovery DVD

The recovery DVD includes an image of the operating system installed on your system at the factory. The recovery DVD, working with the support DVD, provides a comprehensive recovery solution that quickly restores your system to its original working state, provided that your hard disk drive is in good working order. Before using the recovery DVD, copy your data files (such as Outlook PST files) to a USB device or to a network drive and make note of any customized configuration settings (such as network settings).

1. Turn on your ASUS Desktop PC and the ASUS logo appears. Press **F8** to enter the **Please select boot device** menu.
2. Insert the recovery DVD into the optical drive and select the optical drive ("CDROM:XXX") as the boot device. Press **Enter** and then press any key to continue.
3. The **Windows Boot Manager** window appears. Select **Windows Setup [EMS Enabled]** and press **Enter**. Wait when the **Windows is loading files** message appears.
4. Select where to install a new system. Options are:

### **Recover system to a partition**

This option will delete only the partition you select from below, allowing you to keep other partitions, and create a new system partition as drive "C." Select a partition and click **NEXT**.

### **Recover system to entire HD**

This option will delete all partitions from your hard disk drive and create a new system partition as drive "C." Select and click **Yes**.

5. Follow the on-screen instructions to complete the recovery process.



---

You will lose all your data during the system recovery. Make sure that you make a backup of it before recovering the system.

---

6. After the system recovery is completed, you will be asked to eject the support DVD from the optical drive. Click **OK** and the system reboots.
7. After the system reboots, Windows® Vista™ will begin system configurations. Follow the on-screen instructions to complete the process, and then restart the computer.



---

This recovery DVD is for ASUS Desktop PC only. DO NOT use it on other computers. Visit the ASUS website [www.asus.com](http://www.asus.com) for any updates.

---

## Quickly recover your system

1. Turn on your ASUS Desktop PC. When the ASUS logo appears, press **F9** to enter the **System Recovery**.
2. **Windows is loading files** is shown. Wait until the **Recovery CD/DVD** window appears.
3. Follow the onscreen instructions to complete the recovery process. After the system reboots, display resolution and system settings are restored to their default values.

# Troubleshooting

---

Read the following Q&As for troubleshooting guide. If these do not give you answers, you may contact us directly at the contact information provided in the support DVD.

## ***What can I do if my Desktop PC cannot be powered on?***

Check if the power LED on the front panel lights up. It does not light up if no power is supplied to the system.

- Find out if the power cord is plugged in.
- When you use an extension cord or a voltage regulator, ensure that you have plugged it into the wall socket and switched it on.

## ***What can I do if my Desktop PC cannot enter the operating system?***



- Make sure that you use memory modules that the system supports and that you install them properly on the sockets.
- Check if your peripheral devices are compatible with the system. Some USB storage devices, for example, are with different disk drive structure and enter sleep mode easily.

If the above steps do not solve the problem, contact your retailer or perform system recovery using the supplied recovery DVD.



You will lose all your data during the system recovery. Make sure that you make a backup of it before recovering the system.

## ***Why is it that I cannot hear anything from my speakers/headphones?***

Check the volume icon on the Windows® taskbar to see if it is set to mute . If so, double-click this icon to display the volume bar, and then click the mute icon under the bar to cancel the muted mode .

***Why is it that a CD/DVD cannot be read from or written to?***

- Make sure that you use a disc compatible with the optical drive.
- Check if you insert the disc properly or if there is any scratch on the disc.
- Find out if the disc is with write protection.

<b>Manufacturer:</b>	ASUSTeK Computer Inc.
<b>Address:</b>	No. 150, LI-DE RD., PEITOU, TAIPEI 112, TAIWAN
<b>Authorised representative in Europe:</b>	ASUS Computer GmbH
<b>Address:</b>	HARKORT STR. 21-23, 40880 RATINGEN, GERMANY