

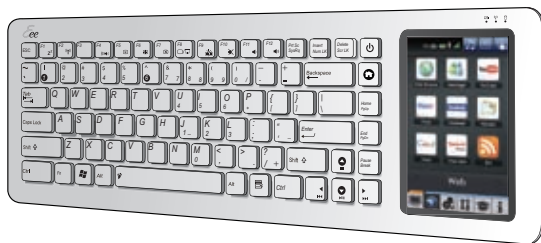

# *EeeKeyboard PC*

easy to learn, work and play



## **EK1542**

### **User Manual**

15G067537200

E4706

First Edition  
February 2010

**Copyright © 2010 ASUSTeK Computer Inc. All Rights Reserved.**

No part of this manual, including the products and software described in it, may be reproduced, transmitted, transcribed, stored in a retrieval system, or translated into any language in any form or by any means, except documentation kept by the purchaser for backup purposes, without the express written permission of ASUSTeK Computer Inc. ("ASUS").

Product warranty or service will not be extended if: (1) the product is repaired, modified or altered, unless such repair, modification or alteration is authorized in writing by ASUS; or (2) the serial number of the product is defaced or missing.

ASUS PROVIDES THIS MANUAL "AS IS" WITHOUT WARRANTY OF ANY KIND, EITHER EXPRESS OR IMPLIED, INCLUDING BUT NOT LIMITED TO THE IMPLIED WARRANTIES OR CONDITIONS OF MERCHANTABILITY OR FITNESS FOR A PARTICULAR PURPOSE. IN NO EVENT SHALL ASUS, ITS DIRECTORS, OFFICERS, EMPLOYEES OR AGENTS BE LIABLE FOR ANY INDIRECT, SPECIAL, INCIDENTAL, OR CONSEQUENTIAL DAMAGES (INCLUDING DAMAGES FOR LOSS OF PROFITS, LOSS OF BUSINESS, LOSS OF USE OR DATA, INTERRUPTION OF BUSINESS AND THE LIKE), EVEN IF ASUS HAS BEEN ADVISED OF THE POSSIBILITY OF SUCH DAMAGES ARISING FROM ANY DEFECT OR ERROR IN THIS MANUAL OR PRODUCT.

SPECIFICATIONS AND INFORMATION CONTAINED IN THIS MANUAL ARE FURNISHED FOR INFORMATIONAL USE ONLY, AND ARE SUBJECT TO CHANGE AT ANY TIME WITHOUT NOTICE, AND SHOULD NOT BE CONSTRUED AS A COMMITMENT BY ASUS. ASUS ASSUMES NO RESPONSIBILITY OR LIABILITY FOR ANY ERRORS OR INACCURACIES THAT MAY APPEAR IN THIS MANUAL, INCLUDING THE PRODUCTS AND SOFTWARE DESCRIBED IN IT.

Products and corporate names appearing in this manual may or may not be registered trademarks or copyrights of their respective companies, and are used only for identification or explanation and to the owners' benefit, without intent to infringe.

# Table of Contents

Safety information .....	v
EK1542 Specifications summary .....	vi
Package contents* .....	vii

## Chapter 1: Getting started

Getting to know your EeeKeyboard PC .....	1-1
Basic features .....	1-1
Additional features .....	1-2
Ultra-wideband features .....	1-4
Getting your EeeKeyboard PC ready .....	1-5
Turning the battery ON/OFF .....	1-5
Charging the battery .....	1-6
Turning your EeeKeyboard PC ON .....	1-7
Starting up for the first time .....	1-7
Turning your EeeKeyboard PC OFF .....	1-8
Putting on Hibernate mode .....	1-8
Shutting down your EeeKeyboard PC .....	1-8
Force shut down your EeeKeyboard PC .....	1-8
Setting up your Ultra-wideband connection .....	1-9
Connecting devices .....	1-11
Connecting an external display wirelessly .....	1-12
Connecting two external displays .....	1-13

## Chapter 2: Using your EeeKeyboard PC

The Easy Mode screen .....	2-1
Using the touch panel .....	2-4
The Touchpad mode screen .....	2-4
Using the touch gestures .....	2-6
Using the keypad .....	2-8
Function keys .....	2-8
Special keys .....	2-10
Keypad overlay .....	2-11
Updating the BIOS .....	2-12
Recovering your system .....	2-13

## Chapter 3: Getting connected

Connecting to the Internet .....	3-1
Wired connection .....	3-1
Connecting to a wireless network .....	3-2
Using ASUS Eee Net .....	3-4
Launching ASUS Eee Net .....	3-4
Creating a group .....	3-5
Joining a group .....	3-5
Using Bluetooth® .....	3-6
Setting up the basic Bluetooth environment .....	3-6
Adding Bluetooth devices .....	3-7

## Appendices

Notices .....	A-1
ASUS Contact information .....	A-6



## Safety information



Disconnect the AC power and peripherals before cleaning. Wipe the EeeKeyboard PC using a clean cellulose sponge or chamois cloth dampened with a solution of nonabrasive detergent and a few drops of warm water then remove any extra moisture with a dry cloth.



**DO NOT** place on uneven or unstable work surfaces. Seek servicing if the casing has been damaged.



**DO NOT** expose to dirty or dusty environments. **DO NOT** operate during a gas leak.



**DO NOT** place together with small items that may scratch or damage the EeeKeyboard PC.



**DO NOT** leave the EeeKeyboard PC on your lap or any part of the body to prevent discomfort or injury from heat exposure.



**DO NOT** expose to strong magnetic or electrical fields.



**DO NOT** expose to or use near liquids, rain, or moisture.



**SAFE TEMP:** This EeeKeyboard PC should only be used in environments with ambient temperatures between 5°C (41°F) and 35°C (95°F).



**DO NOT** place or drop objects on top and do not shove any foreign objects into the EeeKeyboard PC.



**DO NOT** carry or cover the EeeKeyboard PC that is powered ON with any materials, such as a carrying bag, that will reduce air circulation.



**DO NOT** throw the EeeKeyboard PC in municipal waste. Check local regulations for disposal of electronic products.









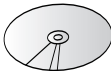

## EK1542 Specifications summary

<b>Display</b>	5" 800 x 480 Touch Panel
<b>OS support</b>	Windows® XP Home edition
<b>CPU</b>	Intel® Atom N270
<b>Chipset</b>	945GSE / ICH7-M
<b>Memory</b>	Onboard DDR2 1GB
<b>Storage</b>	16GB / 32GB SSD
<b>Multimedia decoder</b>	Broadcom 70010/70012 solution
<b>LAN</b>	10/100/1000Mbps
<b>Wireless video transfer</b>	Ultra-wideband technology
<b>Wireless standards</b>	Wi-Fi 802.11b/g/n and Bluetooth V2.1
<b>Power supply</b>	36W adapter
<b>Internal battery life</b>	up to 4 hours
<b>Audio</b>	2 x Built-in high quality stereo speakers High quality mic
<b>I/O ports</b>	<b>EeeKeyboard PC:</b> <ul style="list-style-type: none"><li>- 1 x HDMI port</li><li>- 1 x VGA port</li><li>- 1 x Antenna (Wi-Fi + Ultra-wideband)</li><li>- 1 x LAN port</li><li>- 3 x USB ports</li><li>- 1 x Power (DC) input</li><li>- 2 x Audio jacks (Headphone and Mic-in)</li></ul> <b>Ultra-wideband Receiver:</b> <ul style="list-style-type: none"><li>- 1 x HDMI port</li><li>- 1 x Power (DC) Input port</li></ul>

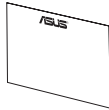

**NOTE:** Specifications are subject to change without prior notice.

## Package contents\*

			
<b>EeeKeyboard PC</b>			
			
<b>Recovery DVD</b>	<b>HDMI cable</b>	<b>Quick Start Guide</b>	<b>User Manual</b>
			
<b>Warranty card</b>	<b>AC adapter</b>	<b>Power cord</b>	
			
<b>Ultra-wideband receiver AC adapter</b>	<b>Ultra-wideband receiver</b>	<b>Wireless antenna (Wi-Fi+Ultra-wideband)</b>	

\* If any of the above items is damaged or missing, contact your retailer.

# Chapter 1

## Getting started

### Getting to know your EeeKeyboard PC

#### Basic features

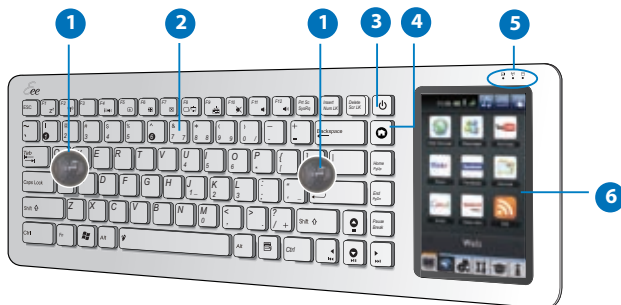

#### 1 Built-in speakers

The EeeKeyboard PC is equipped with two built-in high quality stereo speakers.

#### 2 Illuminated Keypad

The keypad comes with LED light to guide you in dim light or in darkness.

#### 3 Power key

Press to turn on your EeeKeyboard PC. Press for about five seconds to force shut down your EeeKeyboard PC. Press to put your EeeKeyboard PC on hibernate mode. Press again to wake up your EeeKeyboard PC from hibernate mode.

#### 4 Main key

Press to go back to the main page. Press this key to close an unresponsive Easy Mode program and return to the main page.

## 5 LED indicators

These indicators display the status of the battery, wireless connection, and storage device.



**Battery indicator:** Indicates the battery status.

- **Solid green:** Battery is fully-charged.
- **Solid yellow:** Battery is charging.
- **Blinking yellow:** Battery is charging but still at low level.
- **Blinking white:** Battery is running low.



**Wireless indicator:** Indicates the wireless connection status.

- **Solid white:** WLAN function is enabled.



**Storage device indicator:** Indicates the storage device status.

- **Solid white:** Storage device is accessed.
- **Blinking white:** Reading/writing to/from the storage device.

## 6 5" Touch Panel

Lightly touch the screen to navigate through the various features and functions of the EeeKeyboard PC.

## Additional features

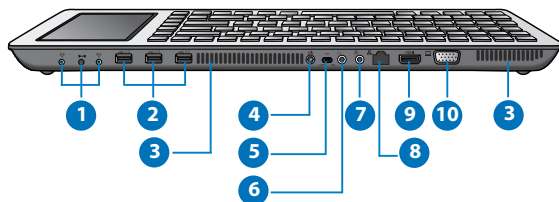

1



### Wireless antenna ports (Wi-Fi + Ultra-wideband)







Insert the bundled wireless antenna into these ports.

2



### USB 2.0 ports

Insert USB devices such as PDAs, scanners, printers, cameras, and storage devices, into these ports.

- |    |   |  |
|----|---|--|
| 3  |   | <b>Air vents</b><br>The air vents allow cool air to enter and warm air to exit the EeeKeyboard PC.   |
| 4  |  | <b>Power (DC) input</b><br>Insert the AC adapter into this port to supply power to the EeeKeyboard PC and charge the internal battery. To prevent damage to the EeeKeyboard PC and battery, always use the bundled AC adapter. |
| 5  |  | <b>Battery switch</b><br>Enables or disables the battery.  |
| 6  |  | <b>Headphone port</b><br>Insert your headphone connector into this jack. Using this jack automatically disables the built-in speakers.   |
| 7  |  | <b>Microphone port</b><br>Insert your microphone connector into this port.   |
| 8  |  | <b>LAN port</b><br>Insert an RJ-45 cable into this port to connect to a network.   |
| 9  |  | <b>HDMI port</b><br>Insert the bundled HDMI cable into this port to connect high-definition multimedia devices.  |
| 10 |  | <b>Display (Monitor) output</b><br>Insert a VGA cable into this port to connect a standard VGA-compatible device such as a monitor or projector to allow viewing on a larger external display.                                 |

## Ultra-wideband features

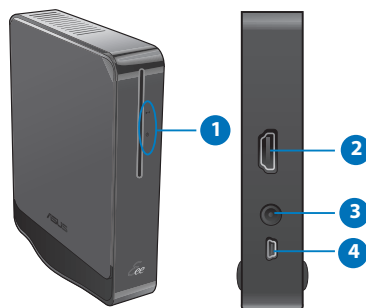

**NOTE:** If the receiver would not keep firmly in place, gently wipe the receiver's bottom with a clean and mildly soapy damp cloth.

### 1 LED indicators

These indicators display the Ultra-wideband connection status.



**Ultra-wideband indicator:** Indicates the Ultra-wideband connection status.

- **Solid white:** Ultra-wideband receiver is connected to the EeeKeyboard PC.
- **Blinking white:** Ultra-wideband connection is active.



**Power indicator:** Indicates that the Ultra-wideband receiver is plugged to a power outlet.

### 2 HDMI port

Insert the bundled HDMI cable into this port to connect high-definition multimedia devices.

3

**DCIN**

Power (DC) Input

Insert the AC adapter into this port to supply power to the Ultra-wideband receiver.

4

Mini-USB port

Insert the mini-USB cable into this port to create a wireless pairing between your EeeKeyboard PC and an additional UWB receiver.

## Getting your EeeKeyboard PC ready

### Turning the battery ON/OFF

Out of the box, the built-in battery is set to OFF mode to prevent the EeeKeyboard PC from accidentally turning ON during transport.

**To turn the battery on/off:**



1. Locate the battery switch at the back of the EeeKeyboard PC.
2. Use a pointed object such as a ballpen to switch on/off the EeeKeyboard PC.



## Charging the battery

To charge the battery:

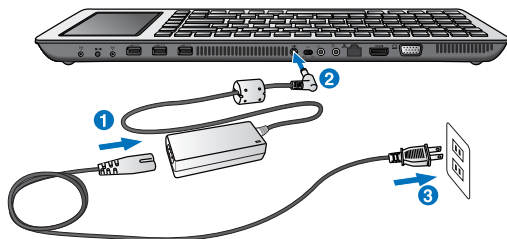

1. Connect the AC power cord to the AC adapter.
2. Connect the AC adapter to the DC-in port at the back of your EeeKeyboard PC.
3. Connect the AC adapter to a power outlet.



### IMPORTANT!

- Use only the AC adapter that comes with your EeeKeyboard PC. Using a different AC adapter may damage your device.
- Ensure that the battery is turned ON before charging the battery. Refer to the section **Turning the battery ON/OFF** for more details.
- When charging, the battery indicator turns yellow. Once fully charged, the battery indicator turns green.

## Turning your EeeKeyboard PC ON

To turn on your EeeKeyboard PC:

- Press the Power key  to turn your EeeKeyboard PC on.



## Starting up for the first time

When you use your EeeKeyboard PC for the first time, a series of screens appear to guide you in configuring the basic settings of your EeeKeyboard PC.

To start up for the first time:

1. Turn your EeeKeyboard PC on.
2. Follow the succeeding onscreen instructions to complete the setup.
3. The system restarts and Easy Mode screen automatically launches.

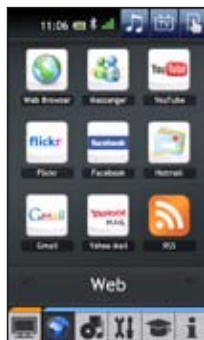



**NOTE:** For more details about using the Easy Mode screen, refer to the section The Easy Mode screen in Chapter 2.

# Turning your EeeKeyboard PC OFF

## Putting on Hibernate mode



### To put on Hibernate mode:

- Press the Power key  to put your EeeKeyboard PC on hibernate mode. To wake up the system, simply press the Power key  again.

Hibernate mode powers down the system and the system quickly resumes its former state of operation within seconds after turning it back on.

## Shutting down your EeeKeyboard PC

### To shut down your EeeKeyboard PC:

1. From the Easy Mode screen, tap the Fun icon , then tap **Windows Desktop** to enter the Windows® environment.
2. Press the Start key  on your EeeKeyboard PC to display the Start menu.
3. Select **Turn off the Computer** > **Turn off** to shut down your EeeKeyboard PC.

## Force shut down your EeeKeyboard PC

### To force shut down your EeeKeyboard PC:

- Press the Power key  for five seconds to force shut down your EeeKeyboard PC.

## Setting up your Ultra-wideband connection

With the Ultra-wideband receiver, the EeeKeyboard PC allows you to wirelessly connect to external video devices within a five-meter range for 720p high-definition video transmission and ten-meter range for non-video transmission.

### To set up your Ultra-wideband connection:



**NOTE:** The Ultra-wideband receiver should be positioned within a clear line of sight to the wireless antenna. Its front (with the Eee logo) must face towards the wireless antenna.

1. Connect all the necessary devices for your Ultra-wideband connection.

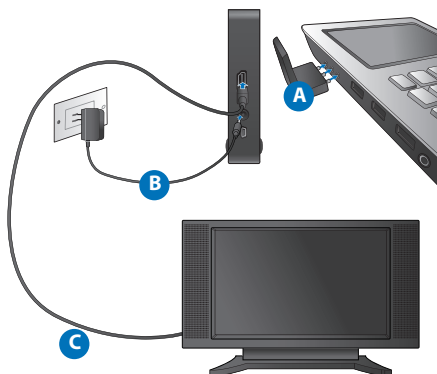

**NOTE:** If your external display freezes or fails to respond, try disconnecting and reconnecting the receiver's AC adapter to the receiver to reestablish the Ultra-wideband connection.

2. From the Easy Mode screen, tap the Ultra-wideband icon  and your EeeKeyboard PC automatically connects to the Ultra-wideband receiver. The LED on the Ultra-wideband receiver turns white to indicate a successful connection.



**TIP:** You may purchase an additional Ultra-wideband receiver to wirelessly connect another device to your EeeKeyboard PC.



#### NOTES:

- If more than one Ultra-wideband receiver is present, select the Ultra-wideband receiver that you want to use to establish the Ultra-wideband connection.
- If the Ultra-wideband receiver failed to establish connection with your EeeKeyboard PC, do the following steps, then try connecting again:
  - Check if the Ultra-wideband receiver is plugged to a power outlet
  - Check if the wireless antenna is connected to the wireless antenna ports.



#### IMPORTANT!

- To use an additional Ultra-wideband receiver, you first need to connect your EeeKeyboard PC and the additional receiver using the mini-USB cable to create a wireless pairing.
- Your EeeKeyboard PC can only connect to one receiver at a time.
- For servicing, ensure to take both the EeeKeyboard PC and the receiver to the authorized service center.

## Connecting devices

You can connect these devices to your EeeKeyboard PC:

- **USB devices** such as cameras, storage devices, PDAs, printers, and scanners.
- **High-definition multimedia devices** such as DVD drives, digital audio devices, computer monitor, and HDTV.
- **VGA-compatible devices** such as a monitor or projector to allow viewing on a larger external display.



**NOTE:** Blu-ray disc format is not supported.

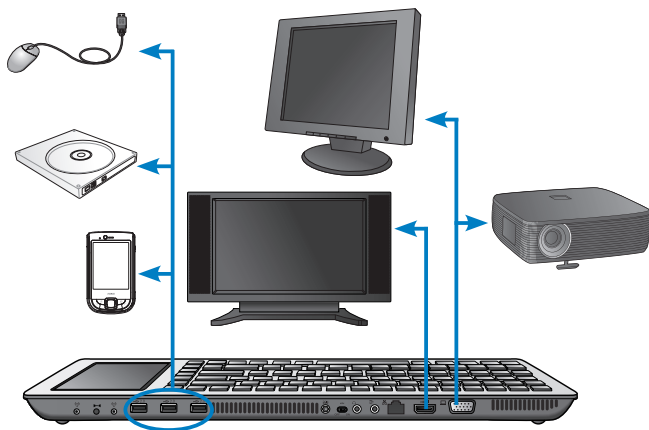



**NOTE:** You can also connect devices to your EeeKeyboard PC wirelessly. For more details, refer to the following sections in this chapter:

- **Setting up your Ultra-wideband connection**
- **Connecting an external display wirelessly**
- **Chapter 3: Getting connected**

## Connecting an external display wirelessly

### To connect an external display wirelessly:

1. Ensure that you have set up your Ultra-wideband connection.



**NOTE:** For more details, refer to the section **Setting up your Ultra-wideband connection** in this chapter.

2. Turn on your EeeKeyboard PC and the external display.
3. On your EeeKeyboard PC touch panel, the Easy Mode screen is displayed. Use the Easy Mode screen to launch various applications on your external display and to configure various settings.



### NOTES:



- On the Easy Mode screen, tap the Touchpad icon  to allow you to use your finger or fingers to navigate the external display from your EeeKeyboard PC.
- For more details on the Easy Mode screen, refer to the section **The Easy Mode screen** in Chapter 2.

## Connecting two external displays

### To connect two external displays:

1. Do any of the following to connect two external displays to your EeeKeyboard PC:
  - Connect one monitor wirelessly and connect the other monitor using a VGA or HDMI cable.
  - Connect two external displays using VGA and HDMI cables.
2. Turn on your EeeKeyboard PC and the external displays.



**IMPORTANT!** When you connect two external displays to your EeeKeyboard PC either via wired or wireless connection, only one external monitor has a display output. Press  +  (<Fn> + <F8>) on your EeeKeyboard PC to toggle between the external displays.



# Chapter 2

## Using your EeeKeyboard PC

### The Easy Mode screen

With the tap of your finger or fingers on the touch panel, the Easy Mode screen enables you to quickly access the Internet, view your photos in slideshow format, play songs on your playlist, view your videos, and launch MSN Messenger or Skype.

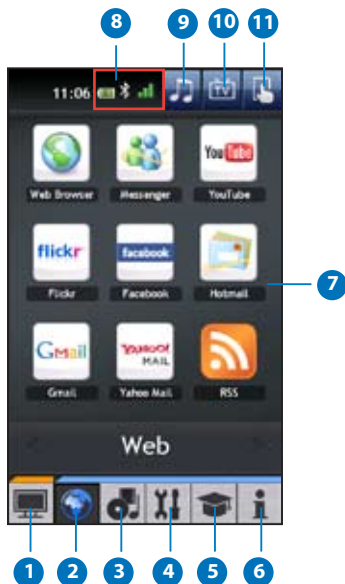

1



### TV & Monitor

Tap this icon to quickly launch your commonly-used applications to the external display.

Icons on this page only appear when an external display is connected to your EeeKeyboard PC.

2



### Web

Tap this icon to quickly access popular online messaging, social networking, and e-mail services websites.



#### NOTES:

- Web browser from the Easy Mode screen allows you to surf and download files into default folders in **My Documents**.
- If you are using a download application, ensure that you set the download destination to the default folders in **My Documents**. This allows you to automatically view the files from Easy Mode applications.
- The preinstalled Skype version in your EeeKeyboard PC is 4.0.0.206. If you install a newer Skype version, you will not be able to use Skype from the Easy Mode screen. However, you can use a newer Skype version in Windows® environment.
- If you updated Skype to a new version, but still want to use it in Easy mode, uninstall Skype first and then reinstall Skype 4.0.0.206 from the Recovery DVD.

3



### Fun

Quick access to media/video players and games.



**NOTE:** The Windows Desktop icon allows you to enter the Windows® environment when your EeeKeyboard PC is in standalone mode.

4



### Tools & Setting

Quick access to various tools to help you configure various settings.

5



### Learning

Quick access to learning applications.

6



### Info

Quick access to the latest information such as news and weather information.

7

### Touch Panel

Shows various applications and tools under each Easy Mode features.

8

### Status indicators



Indicates that the Bluetooth function is enabled.



Indicates the wireless connection status. Tap this icon to connect to a wireless network.



Indicates the battery status.

9



### Music

Tap this icon to display the media player. This icon appears only when there is music that is currently playing on the media player in Easy mode screen.

10



### Wi-Fi

Tap this icon to enable your Ultra-wideband connection.

11



### Touchpad

Tap this icon to use your finger or fingers to navigate the external display from your EeeKeyboard PC. This icon only appears when your EeeKeyboard PC is connected to an external display.

## Using the touch panel







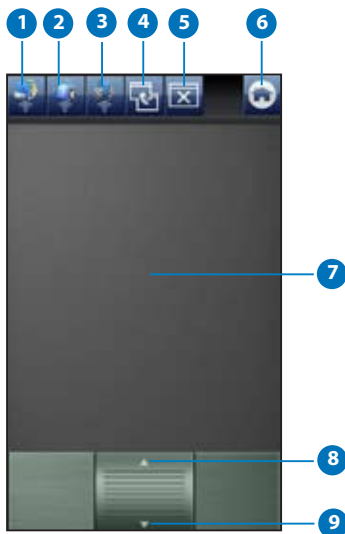

### The Touchpad mode screen

The Touchpad icon  enables you to use touch gestures to navigate your external display from your EeeKeyboard PC.



**IMPORTANT!** The Touchpad icon only appears when your EeeKeyboard PC is connected to an external display.



- 
- |          |  |   |
|----------|--|---|
| <b>1</b> |                       | Launches the Picture command center.                          |
| <hr/>    |  |   |
| <b>2</b> |                       | Launches the Media Player command center.                     |
| <hr/>    |  |   |
| <b>3</b> |                       | Launches the Total Media Theater (TMT) player command center. |
| <hr/>    |  |   |
| <b>4</b> |                       | Switches between applications.                                |
| <hr/>    |  |   |
| <b>5</b> |                       | Closes the current program on the external display.           |
| <hr/>    |  |   |
| <b>6</b> |                       | Enables you to go back to the previous page.                  |
| <hr/>    |  |   |
| <b>7</b> | Move your finger or fingers on this screen to navigate your external display from your EeeKeyboard PC. |   |
| <hr/>    |  |   |
| <b>8</b> |                       | Scrolls up in documents or webpages.                          |
| <hr/>    |  |   |
| <b>9</b> |                       | Scrolls down in documents or webpages.                        |
-

## Using the touch gestures

Touch gestures are movements that you make with your finger or fingers to select items or navigate around your Eeekeyboard PC's 5" touch panel.



**NOTE:** Use light pressure when making a touch gesture.



**IMPORTANT!** Do not use any objects in place of your finger or fingers to operate the touch panel. Doing so may damage or scratch the touch panel's surface.

## Standard gestures

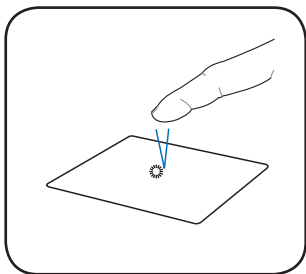

### Single tap

Tap once to select an item. This gesture mimics the left-click action on a standard mouse.

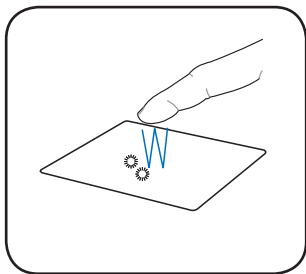

### Double tap

Tap twice to launch an application. This gesture mimics the left double-click action on a standard mouse.



**NOTE:** Tap the touchpad for more than two seconds to initialize the right-click function.

## Special IE gestures (for Internet browsing only)

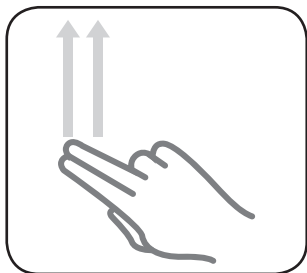

### Zoom in

Keeping your index and middle fingers together, move your fingers in an upward motion.

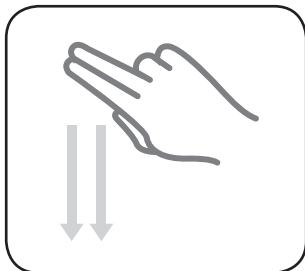

### Zoom out

Keeping your index and middle fingers together, move your fingers in a downward motion.

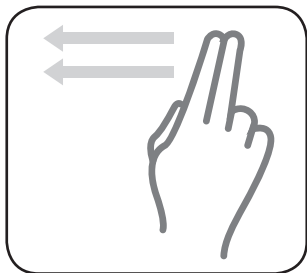

### Previous page

Keeping your index and middle fingers together, move your fingers in a leftward motion.

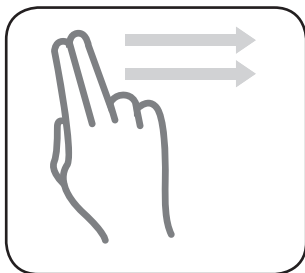

### Next page

Keeping your index and middle fingers together, move your fingers in a rightward motion.

## Using the keypad



**NOTE:** The keys on the keypad vary with country/region.

### Function keys

Use the Function key  combined with another specific key to perform an action.



+



**Sleep:** Puts the system on Sleep/Standby Mode.



**NOTE:** Press any key to wake up the system.



+



**Wireless/Bluetooth:** Toggles the internal wireless LAN or Bluetooth ON or OFF. When enabled, the corresponding wireless indicator lights up.



**NOTE:** The default setting is WLAN ON / Bluetooth ON.



+



**Audio Switch:** Switches between EeeKeyboard PC Speaker, HDMI audio output, and Ultra-wideband audio output.



**NOTES:**

- To switch to HDMI or Ultra-wideband audio output, HDMI or Ultra-wideband device must be connected.
- After pressing <Fn> + <F4>, close and relaunch the media player to initiate change.





**Brightness down:** Decreases the display brightness.



**Brightness up:** Increases the display brightness.



**LCD on/off:** Turns the display backlight on/off.



**LCD/Monitors switch:** Toggles between two external displays connected to your EeeKeyboard PC via wired or wireless connections.



**LED Keypad on/off:** Turns the LED Keypad on/off.



**Mute:** Turns the volume on/off.



**Volume down:** Decreases the volume.



**Volume up:** Increases the volume.



**Number Lock:** Toggles the Number Lock function on/off.



**Scroll Lock:** Toggles the Scroll Lock function on/off.



**Stop:** Stops the media file, such as video or audio file, that is currently playing.



**Play/Pause:** Plays or pauses the media file that is currently playing.



**Previous:** Goes back to the previous track of the currently playing media file.



**Next:** Goes to the next track of the currently playing media file.



**Page Up:** Scrolls up in documents or in webpages.



**Page Down:** Scrolls down in documents or in webpages.



**Super Hybrid Engine Key:** Shows the various power-saving modes.

## Special keys



Displays the Windows® XP Start menu.



Activates the properties menu and is equivalent to right-clicking the touchpad/mouse on an object.



Press to go back to the main page.  
If an Easy Mode program is not responding, press this key to close the running program and return to the main page.



When CPU usage is high and the system is not running properly, press this key to close all programs.

## Keypad overlay

Some of the keys have numeric or character overlay functions. To key in letters and symbols, simultaneously press **Fn** + **Insert Num/Lk** to enable the Number Lock function. To enter uppercase letters or enter the upper character, press the Shift key and the key that you want to use.



## Updating the BIOS

ASUS Update, a pre-installed utility in your EeeKeyboard PC, allows you to manage, save, and update the EeeKeyboard PC BIOS in Windows® environment.



### TIPS:

- ASUS Update requires an Internet connection either through a network or an Internet Service Provider (ISP).
- This utility is also available in the Recovery DVD that comes with your EeeKeyboard PC package.



**WARNING!** Updating the BIOS is potentially risky. DO NOT update the BIOS unless it is absolutely necessary.

### To update the BIOS:

1. From the Easy Mode screen, tap the Fun icon , then tap **Windows Desktop** to enter the Windows® environment.
2. Select **Start > All Programs > ASUS EeeKeyboard PC Applications > ASUSUpdate for Eee Keyboard PC > ASUSUpdate** to launch the ASUS Update utility.
3. From the dropdown list, select any of the updating process:

#### **Updating from the Internet**

- a. Select **Update BIOS from the Internet**, then tap **Next**.





- b. Select the ASUS FTP site nearest you to avoid network traffic, or tap **Auto Select** then tap **Next**.
- c. From the FTP site, select the BIOS version that you wish to download then tap **Next**.

#### **Updating from a BIOS file**

- a. Select **Update BIOS from a file**, then tap **Next**.
  - b. Locate the BIOS file from the Open window, then tap **Open**.
4. Follow the onscreen instructions to complete the updating process.

## Recovering your system

The bundled Recovery DVD assists you in reinstalling the operating system and restoring it to its original working state.



**WARNING!** All data will be lost during the recovery process. Before recovering the system, ensure that you back up all your data and take note of any customized settings such as the network settings.

#### **To recover your system:**

1. Connect an external optical disk drive to your EeeKeyboard PC's USB port.
2. Turn on your EeeKeyboard PC.
3. Insert the Recovery DVD into the external optical disk drive.
4. Restart the system and press **<F8>** when the ASUS logo appears. Select the external optical disk drive as the boot device.





5. Select where to install a new system. Options are:

#### **Recover system to a partition**

This option deletes only the partition you selected, allows you to keep other partitions, and creates a new system partition as drive "C."

#### **Recover system to entire HD**

This option deletes all partitions from your hard disk drive and creates a new system partition as drive "C."

6. A confirmation screen pops up. Tap **Next** to confirm.
7. Tick **I accept** and tap **Next**.
8. A list displays the contents you are going to recover. Tap **Yes** to confirm.
9. After the system restarts, Windows® XP begins its system configurations. Follow the onscreen instructions to complete the process. Adjust the screen to a suitable display resolution.



#### **NOTES:**

- The ASUS Recovery DVD is for the ASUS EeeKeyboard PC only. DO NOT use it on other systems.
- Visit the ASUS website at [www.asus.com](http://www.asus.com) for updates.



# Chapter 3

## Getting connected

### Connecting to the Internet

#### Wired connection

Use an RJ-45 cable to connect your EeeKeyboard PC to an ADSL modem or a local area network (LAN).



**IMPORTANT!** On the Easy Mode screen, tap the Fun icon  then select **Windows Desktop** to enter the Windows® environment. Set up your Internet settings for the first time from the Windows® environment.

#### Connecting via an ADSL modem

##### To connect via an ADSL modem:

- Connect one end of the RJ-45 cable to the LAN port of the ADSL modem and the other end to the LAN port at the back of the EeeKeyboard PC.



**NOTE:** If you have difficulty connecting to the Internet via an ADSL modem, contact your Internet Service Provider (ISP).

## Connecting via the Local Area Network (LAN)

### To connect via LAN:

- Connect one end of the RJ-45 cable to your LAN and the other end to the LAN port at the back of the EeeKeyboard PC.



**NOTE:** If you have difficulty connecting to the Internet via LAN, contact your network administrator.

## Connecting to a wireless network

### To connect to a wireless network:

1. Connect the wireless antenna to the wireless antenna ports at the back of the EeeKeyboard PC.
2. From the Easy Mode screen, tap the wireless icon  to launch the WiFi Setting screen.

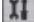

**TIP:** You may also tap the Tools & Setting icon , then select **WiFi** to launch the WiFi Setting screen.

3. The system automatically searches for available networks.
4. From the list, select the network then tap **Connect**. Tap **Refresh** to refresh the list.



**IMPORTANT!** You may need to key in a password or network key to access a secured wireless network.





- If you want to manually key in the network's wireless settings, tap **manual**. Key in the SSID (network name) and select the network authentication and data encryption methods.

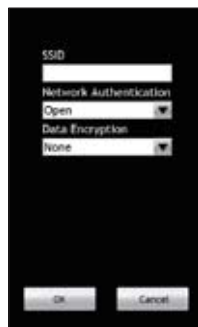

5. You may now start to surf the Internet, send and receive e-mail messages, or chat online using the Easy Mode screen on your EeeKeyboard PC.



**NOTE:** For more details, refer to the section **The Easy Mode screen** in Chapter 2.

## Using ASUS Eee Net

ASUS Eee Net is a program that allows you to create a home network and file sharing system.



### IMPORTANT!

- Before using ASUS Eee Net, ensure the following:
  - You have wired or wireless Internet connection.
  - Your EeeKeyboard PC is connected to a wired or wireless network.

## Launching ASUS Eee Net

### To launch ASUS Eee Net:

- From the Shortcuts page on the Easy Mode screen, tap **Eee Net** to launch ASUS Eee Net.



**NOTE:** For more details on using the ASUS Eee Net features, tap the **Tutorial** tab on the Eee Net screen.



### IMPORTANT!

- You need to create a group first before you can start using the features of ASUS Eee Net.
- When sharing contents over a wireless network, ensure that all computers in the group are using the same network authentication and data encryption methods.

## Creating a group



### IMPORTANT!

- Ensure that you copy the Eee Net installation file to a storage device and install it to the computers that you want to include in a group.
- Obtain the Eee Net installation file from **Options** tab > **Eee Net Installation File** > **Get the Eee Net installation** on the Eee Net screen.

### To create a group:

1. Launch ASUS Eee Net.
2. From the Eee Net screen, tap **Group** > **Create a Group**.
3. Key in a unique name for your **Group Name** and assign a password for your **Group Password**.
4. When done, click **Create**.

## Joining a group

### To join a group:

1. Launch ASUS Eee Net.
2. From the Eee Net screen, tap **Group** > **Join a Group**.
3. In the **Choose a Group** dropdown list, select the group that you want to join.
4. Key in your user name.
5. When done, click **Join**.



**IMPORTANT!** The computers that you want to include in a group should be connected to the same access point or router.

## Using Bluetooth®

Bluetooth® allows your EeeKeyboard PC to wirelessly communicate with other Bluetooth devices, such as computers and mobile devices, within a short range of about ten meters or 30 feet.



**NOTE:** By default, the Bluetooth function is turned on on your EeeKeyboard PC.

## Setting up the basic Bluetooth environment

Your EeeKeyboard PC is equipped with a built-in Bluetooth transceiver. Before you can begin to use the Bluetooth function on your EeeKeyboard PC, you need to set up the basic Bluetooth settings.

### To set up the basic Bluetooth environment:

1. Connect an external display to your EeeKeyboard PC.

2. If you do not see the Bluetooth indicator  on the Easy Mode screen, press



(<Fn> +

<F2>) on your EeeKeyboard PC until **WLAN OFF & Bluetooth ON** or **WLAN & Bluetooth ON** is shown.



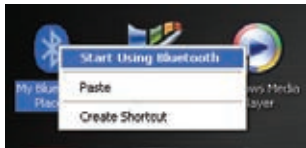

3. Tap **My Bluetooth Places** and press  on your EeeKeyboard PC to right-click on it. Select **Start Using Bluetooth** from the menu.
4. Follow the onscreen instructions to finish your Bluetooth setup.



## Adding Bluetooth devices

You may use peripherals such as a Bluetooth printer, or mouse with your EeeKeyboard PC.

### To add other Bluetooth-enabled devices:

1. From the Windows® taskbar, tap the Bluetooth icon  and press  on your EeeKeyboard PC to right-click on it. Select **Add a Bluetooth Device** from the menu. The Bluetooth Setup Wizard appears.
2. Click **Next** to start searching for other Bluetooth devices.
3. From the list of available Bluetooth devices, select the device you want to use with your EeeKeyboard PC, then click **Next**.
4. Select **Don't use a passkey** and click **Next** to add the device.
5. Click **Finish** when done.



# Appendices

## Notices

### REACH

Complying with the REACH (Registration, Evaluation, Authorisation, and Restriction of Chemicals) regulatory framework, we published the chemical substances in our products at ASUS REACH website at <http://green.asus.com/english/REACH.htm>.

### Federal Communications Commission Statement

This device complies with FCC Rules Part 15. Operation is subject to the following two conditions:

- This device may not cause harmful interference.
- This device must accept any interference received, including interference that may cause undesired operation.

This equipment has been tested and found to comply with the limits for a class B digital device, pursuant to Part 15 of the Federal Communications Commission (FCC) rules. These limits are designed to provide reasonable protection against harmful interference in a residential installation. This equipment generates, uses, and can radiate radio frequency energy and, if not installed and used in accordance with the instructions, may cause harmful interference to radio communications. However, there is no guarantee that interference will not occur in a particular installation. If this equipment does cause harmful interference to radio or television reception, which can be determined by turning the equipment off and on, the user is encouraged to try to correct the interference by one or more of the following measures:

- Reorient or relocate the receiving antenna.
- Increase the separation between the equipment and receiver.
- Connect the equipment into an outlet on a circuit different from that to which the receiver is connected.
- Consult the dealer or an experienced radio/TV technician for help.



**WARNING!** The use of a shielded-type power cord is required in order to meet FCC emission limits and to prevent interference to the nearby radio and television reception. It is essential that only the supplied power cord be used. Use only shielded cables to connect I/O devices to this equipment. You are cautioned that changes or modifications not expressly approved by the party responsible for compliance could void your authority to operate the equipment.

(Reprinted from the Code of Federal Regulations #47, part 15.193, 1993.  
Washington DC: Office of the Federal Register, National Archives and  
Records Administration, U.S. Government Printing Office.)

## FCC Radio Frequency (RF) Exposure Caution Statement

This equipment complies with FCC radiation exposure limits set forth for an uncontrolled environment. To maintain compliance with FCC RF exposure compliance requirements, please avoid direct contact to the transmitting antenna during transmitting. End users must follow the specific operating instructions for satisfying RF exposure compliance.



**WARNING!** Any changes or modifications not expressly approved by the party responsible for compliance could void the user's authority to operate this equipment. "The manufacture declares that this device is limited to Channels 1 through 11 in the 2.4GHz frequency by specified firmware controlled in the USA."



## RF Exposure warning

- The equipment complies with FCC RF exposure limits set forth for an uncontrolled environment.
- The equipment must not be co-located or operated in conjunction with any other antenna or transmitter.

## Declaration of Conformity (R&TTE directive 1999/5/EC)

The following items were completed and are considered relevant and sufficient:

- Essential requirements as in [Article 3]
- Protection requirements for health and safety as in [Article 3.1a]
- Testing for electric safety according to [EN 60950]
- Protection requirements for electromagnetic compatibility in [Article 3.1b]
- Testing for electromagnetic compatibility in [EN 301 489-1] [EN 301 489-17] [EN 301 489-33] & [EN 301]
- Effective use of the radio spectrum as in [Article 3.2]
- Radio test suites according to [EN 300 328-2] & [EN 302 065]

## CE Mark Warning

This is a Class B product, in a domestic environment, this product may cause radio interference, in which case the user may be required to take adequate measures.



## Wireless Operation Channel for Different Domains

N. America	2.412-2.462 GHz, 3.1~10.6 GHz
Japan	2.412-2.484GHz, 4.2~4.8 GHz, 7.25~10.25 GHz
Europe ETSI	2.412-2.472 GHz, 4.2~4.8 GHz, 6~8.5 GHz

## France Restricted Wireless Frequency Bands

Some areas of France have a restricted frequency band. The worst case maximum authorized power indoors are:

- 10mW for the entire 2.4 GHz band (2400 MHz–2483.5 MHz)
- 100mW for frequencies between 2446.5 MHz and 2483.5 MHz



**NOTE:** Channels 10 through 13 inclusive operate in the band 2446.6 MHz to 2483.5 MHz.

There are few possibilities for outdoor use: On private property or on the private property of public persons, use is subject to a preliminary authorization procedure by the Ministry of Defense, with maximum authorized power of 100mW in the 2446.5–2483.5 MHz band. Use outdoors on public property is not permitted.

In the departments listed below, for the entire 2.4 GHz band:

- Maximum authorized power indoors is 100mW
- Maximum authorized power outdoors is 10mW

Departments in which the use of the 2400–2483.5 MHz band is permitted with an EIRP of less than 100mW indoors and less than 10mW outdoors:



01 Ain	02 Aisne	03 Allier	05 Hautes Alpes
08 Ardennes	09 Ariège	11 Aude	12 Aveyron
16 Charente	24 Dordogne	25 Doubs	26 Drôme
32 Gers	36 Indre	37 Indre et Loire	41 Loir et Cher
45 Loiret	50 Manche	55 Meuse	58 Nièvre
59 Nord	60 Oise	61 Orne	63 Puy du Dôme
64 Pyrénées Atlantique	66 Pyrénées Orientales	67 Bas Rhin	68 Haut Rhin
70 Haute Saône	71 Saône et Loire	75 Paris	82 Tarn et Garonne
84 Vaucluse	88 Vosges	89 Yonne	90 Territoire de Belfort
94 Val de Marne			

This requirement is likely to change over time, allowing you to use your wireless LAN card in more areas within France. Please check with ART for the latest information ([www.art-telecom.fr](http://www.art-telecom.fr))



**NOTE:** Your WLAN Card transmits less than 100mW, but more than 10mW.

## IC Radiation Exposure Statement for Canada

This equipment complies with IC radiation exposure limits set forth for an uncontrolled environment. To maintain compliance with IC RF exposure compliance requirements, please avoid direct contact to the transmitting antenna during transmitting. End users must follow the specific operating instructions for satisfying RF exposure compliance.

Operation is subject to the following two conditions:

- This device may not cause interference.
- This device must accept any interference, including interference that may cause undesired operation of the device.

This device should be used only as specified within this manual to meet RF exposure requirements. Using this device in a manner inconsistent with this manual could lead to excessive RF exposure conditions.

This device and its antenna(s) must not be co-located or operating in conjunction with any other antenna or transmitter.

Country Code selection feature to be disabled for products marketed to the US/CANADA.

This Class [B] digital apparatus complies with Canadian ICES-003. Cet appareil numérique de la classe [B] est conforme à la norme NMB-003 du Canada

## ASUS Contact information

### ASUSTeK COMPUTER INC. (Asia Pacific)

Address	15 Li-Te Road, Peitou, Taipei, Taiwan 11259
Telephone	+886-2-2894-3447
Fax	+886-2-2890-7798
Website	<a href="http://www.asus.com.tw">www.asus.com.tw</a>

#### *Technical Support*

Telephone	+86-21-3842-9911
Online support	<a href="http://support.asus.com">support.asus.com</a>

### ASUS COMPUTER INTERNATIONAL (America)

Address	800 Corporate Way, Fremont, CA 94539, USA
Telephone	+1-510-739-3777
Fax	+1-510-608-4555
Website	<a href="http://usa.asus.com">usa.asus.com</a>

#### *Technical Support*

Telephone	+1-812-282-2787
Support fax	+1-812-284-0883
Online support	<a href="http://support.asus.com">support.asus.com</a>

## ASUS COMPUTER GmbH (Germany and Austria)

Address Harkort Str. 21-23, D-40880 Ratingen,  
Germany  
Fax +49-2102-9599-11  
Online contact [www.asus.com.de/sales](http://www.asus.com.de/sales)

### Technical Support

Telephone (Component) +49-1805-010923\*  
Telephone (System/  
Notebook/Eee/LCD) +49-1805-010920\*  
Support fax +49-2102-959911  
Online support [www.asus.com.de/support](http://www.asus.com.de/support)  
Website [www.asus.com.de/news](http://www.asus.com.de/news)

\* EUR 0.14/minute from a German fixed landline; EUR 0.42/minute from a mobile phone.

<b>Manufacturer:</b>	<b>ASUSTeK Computer Inc.</b>  Tel: +886-2-2894-3447  Address: No. 150, LI-TE RD., PEITOU, TAIPEI 112, TAIWAN
<b>Authorised representative in Europe:</b>	<b>ASUS Computer GmbH</b>  Address: HARKORT STR. 21-23, 40880 RATINGEN, GERMANY