

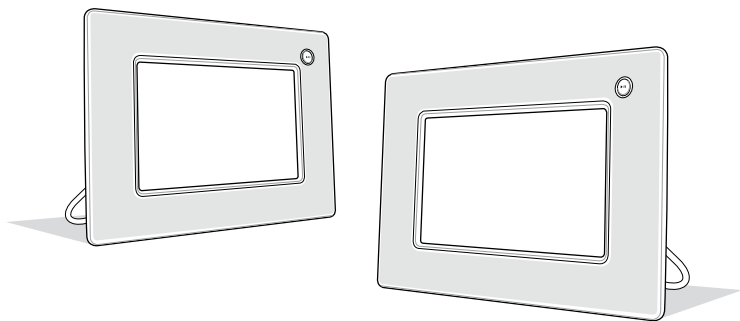

UFOTO

UF735

Quick Start Guide



In the package box

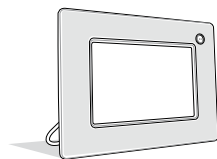

uFOTO UF735



Quick Start Guide

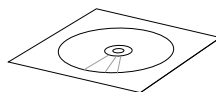

Support CD

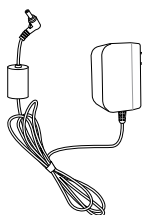

Power adaptor

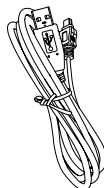

USB cable



Warranty card

Suggested device with photos / MP3 files:

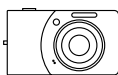

Digital camera
(under mass storage mode)



USB flash disk



computer



memory card

System requirements for Sub-Display function

Minimum requirements

Windows XP

1GHz CPU

512MB RAM

150MB available HD space

Recommended specifications

Windows XP

2GHz CPU

1GB RAM

150MB available HD space

uFOTO profile

Front view

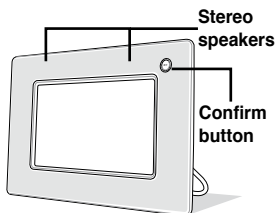

Back view

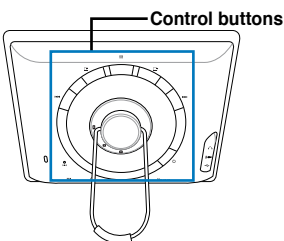

Side view

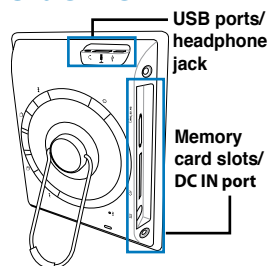

Control buttons (in the back panel)

Locate the control buttons in the back panel according to the following table.

Button	Function
	Single select, Volume control hotkey, Photo and calendar selection switch
	Exit
	Menu for advanced selection
	Right / Down
	Left / Up
	Confirm / Play or Pause / Quick Power On
	Power On/Off

Start the device

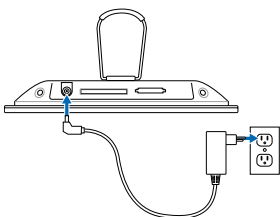

Connect the bundled power adaptor from your uFOTO to a power outlet.

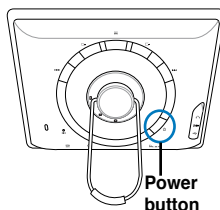

Press the power button to power on the device.

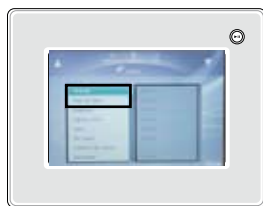

Go to the **Setting** menu to set the correct time/date and your desired language.

- is for quick power on only; you cannot press to turn off the device. Press to turn on or off your uFOTO normally.

uFOTO placement

With a rotating support stand, you can position your uFOTO either vertically or horizontally on a stable and even surface.

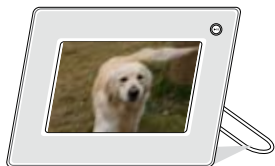

Horizontal placement

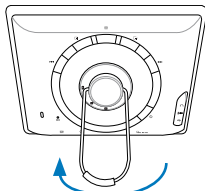

Rotate the support stand 90° clockwise



Vertical placement

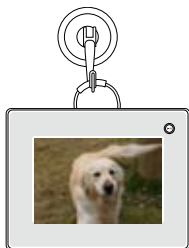

Hanging on a hook

- The display automatically rotates 90 degrees clockwise as you place the uFOTO vertically on an even surface.
- Make sure that the hook on which you will hang your uFOTO is firmly fixed on a flat surface. Otherwise, your uFOTO may drop down and cause damage!

Installing the ASUS uFOTO Utility

To normally use the Sub-Display function and the Data Synchronization, make sure to install the ASUS uFOTO Utility

1. Place the support CD into the optical drive.
2. Double-click the **ASUS uFOTO Utility** icon, then follow the on-screen instructions to finish the installation.
3. Restart your computer after the installation.

Viewing photos

Viewing photos from your memory card

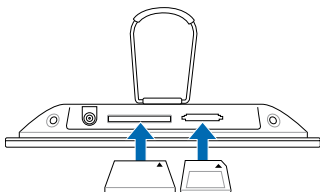

Insert your memory card to the card slot of the UFOTO.

- Left slot: CF card
- Right slot: xD/MMC/SD/MS card



Go to the Photo Frame menu to select your card type, then you will see the preview window.

Viewing photos from your USB device

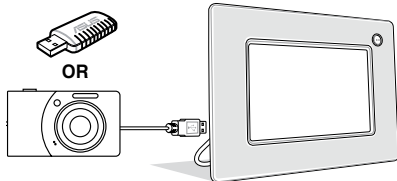

Connect your digital camera (**under mass storage mode**) /USB flash disk to the UFOTO.



Go to the Photo Frame menu to select **USB Flash**, then you will see the preview window.

Viewing photos from your computer

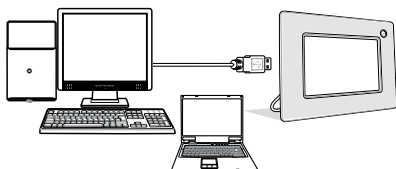

Connect the UFOTO to your computer as a mass storage or a sub-screen.



Go to the Photo Frame menu to select **My uFOTO Picture**, then you will see the preview window.

Listening to MP3s

Connect your USB device, memory card, or computer to your uFOTO following the instructions on page 4.



Music length /
Elapsed time

- When connecting your uFOTO to your computer, go to the Photo Frame menu to select **My uFOTO Music**, then you will see the playlist window.
- Press  to adjust the volume and playback mode for the currently playing MP3 file.
- The uFOTO only supports files of **.mp3** format.

Calendar

Go to **Calendar > Calendar Slideshow** and select the photo source. Press , then the calendar screen appears.





Go to **Calendar > Reminiscence** to quickly and easily search for a certain photo according to the date when the photo was taken.

Calendar Slideshow



Reminiscence



- Use  and  to select the field (mm / dd / yyyy) and change the values. Press  to confirm the setting.
- Press  to adjust settings for the displayed photos and the playing MP3.

Using the softwares

Connect your uFOTO to your computer first.

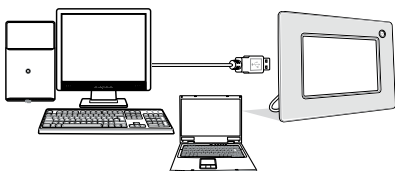

Connect your uFOTO with your computer using the bundled USB cable.

- Before using the following utilities, make sure that you have installed the **ASUS uFOTO Utility**.

Data Synchronization

Go to **Sub-Display > Mass Storage**, then double-click the **ASUS uFOTO Utility** icon on the computer desktop to start the **ASUS uFOTO Folder Sync** utility.

Copy your favorite MP3 files to the **My uFOTO Music** folder and photos to the **My uFOTO Picture** folder.

- Press the **Auto** button start the synchronization.
- Press the **To Sync My uFOTO Photo** button to simply synchronize the **My uFOTO Picture** folder.
- Press the **To Sync My uFOTO Music** button to simply synchronize the **My uFOTO Music** folder.
- Before synchronizing files, make sure to check if the files are already in **C:\My Documents\My uFOTO Picture** or **C:\My Documents\My uFOTO Music**.

Sub-Display

Go to **Sub-Display > Sub-Display**, then double-click the **Sub-Display** icon on the computer desktop to start the **ASUS Sub-Display Utility**. The Sub-Display control panel appears on the computer desktop.



Click **Advanced** to adjust the image settings including Brightness, Contrast, Quality, Speed, and Display resolution selection.



Duplication mode

In the control panel, select **Duplicated**, then adjust the position of the window on your uFOTO by dragging the same screen with the hand-shaped cursor in the control panel.



Hand-shaped cursor



Selection mode



checkbox

In the control panel, select **Selected**, then move the scroll bar in the preview screen to select the window you want to display on the uFOTO.

When decided, check the checkbox on the down right side of the preview screen.

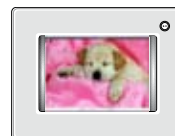

Extension mode

In the control panel, select **Extended**, then drag the current viewing window outside of the computer desktop window. Adjust the position of the window on your uFOTO by dragging the same screen with the hand-shaped cursor in the control panel.

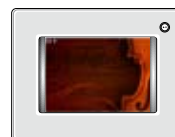

You can also extend part of the current viewing window to the uFOTO.

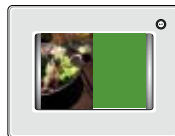

Troubleshooting

uFOTO does not turn on.

- Check if the adapter is properly plugged.
- Check if your uFOTO is fully charged.

The battery remaining indicator is incorrect

- The phenomenon occurs when you are using your uFOTO in an extremely hot or cold environment.
- The displayed battery remaining differ from the current one. Fully discharge and then recharge the built-in battery to correct the display.
- The built-in battery is discharged. Plug the adaptor into your uFOTO for charging.

I cannot launch the Sub-Display function

- The USB cable is not well connected.
- The ASUS uFOTO utility is not completely installed. Refer to page 4 and re-install the utility.
- The Sub-Display function cannot work with the Mass Storage mode simultaneously. Make sure that you are not in the Mass Storage mode prior to launching the Sub-Display function.

I cannot import photos or MP3 files into uFOTO

- The internal memory is full. Remove some files from your uFOTO.

The LCD brightness is not stable

- Check if the AI Light function is enabled. If you enable this function, the LCD backlight will auto-adjust according to the surrounding environments.

More help

- Refer to the digital User manual that is in the support CD.
- Go to the ASUS website (<http://www.asus.com>) for updated information.

This image shows a single sheet of white paper with horizontal ruling lines. The lines are evenly spaced and run across the width of the page. There are no margins, text, or other markings on the paper.