

Eee PC 硬體使用手冊

Eee PC 701SD Series

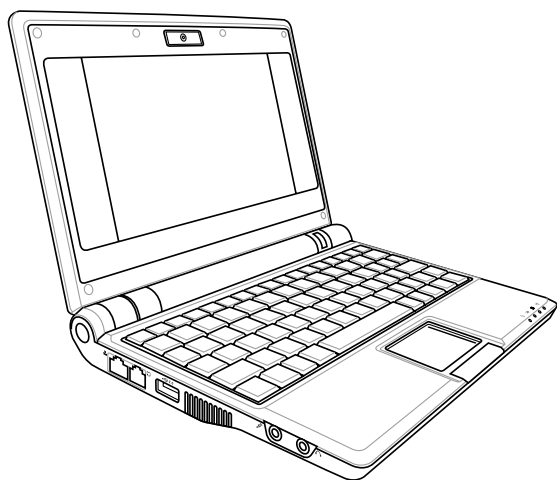

版權說明

版權所有・不得翻印 ©2008 華碩電腦

本使用手冊包括但不限於其所包含的所有資訊受到著作權法之保護，未經華碩電腦股份有限公司（以下簡稱「華碩」）許可，不得任意地仿製、拷貝、謄抄、轉譯或為其他使用或處分。

免責聲明

本使用手冊沒有任何型式的擔保、立場表達或其它暗示。若有任何因本使用手冊或其所提到之產品的所有資訊，所引起直接或間接的資料流失、利益損失或事業終止，華碩及其所屬員工恕不為其擔負任何責任。除此之外，本使用手冊所提到的產品規格及資訊僅供參考，內容亦會隨時更新，恕不另行通知。華碩不負責本使用手冊的任何錯誤或疏失。

本使用手冊中所提及的產品名稱僅做為識別之用，而前述名稱可能是屬於其他公司的註冊商標或是著作權。

當下列兩種情況發生時，本產品將不再受到華碩公司之保固及服務：

- (1) 該產品曾經非華碩授權之維修、規格更改、零件替換。
- (2) 產品序號模糊不清或喪失。

產品規格或驅動程式改變，使用手冊都會隨之更新。更新的詳細說明請您造訪華碩的客戶服務網 <http://support.asus.com.tw>，或是直接與華碩資訊產品技術支援專線 0800-093-456 聯絡。

目錄

目錄.....	3
安全說明	5
關於這本使用手冊	6
提示符號	6

第 1 章 認識您的 Eee PC

外觀介紹	8
上視圖	8
後視圖	9
底視圖	10
左視圖	11
右視圖	11
設定您的電腦	12
電池的安裝與取出	12
接上電源	13
開機	14
關機	15
緊急關機	15
觸控板的使用	16

第 2 章 開始使用您的 Eee PC

首次開機	20
鍵盤的使用	22
桌面模式	23
輸入法	24
電源模式	24
Super Hybrid Engine 說明	25
調整視窗位置	26

目錄

附錄

商標聲明	28
周邊裝置合格供應商列表.....	29
Federal Communications Commission Statement.....	33
GNU General Public License	35
技術支援與服務.....	45

安全說明

在您使用本產品之前，請先詳細閱讀以下指引的使用原則，並遵守這些規則，可以增加產品的使用壽命，並可以避免發生危險或觸犯法律。



請勿用手觸摸或按壓顯示器，如此將可能造成顯示器損壞。



請勿將電池存放靠近火源或是丟入燃燒的火堆中，有可能造成爆炸的意外，請支持回收廢棄電池。



避免在灰塵飛揚或是環境髒亂的場所使用電腦（灰塵容易引起系統故障）。



使用合格的電池與配件。只能使用原廠認可或推薦的電池與配件，請勿使用其他類別或不知是否相容產品或配件，否則可能會損壞電腦。



請勿將電腦放在重心不穩的物品上。



請勿放置重物在電腦上，電腦上面亦不可以堆疊書本紙張等物品，亦請勿用力蓋上液晶顯示螢幕上蓋，避免液晶顯示螢幕損壞。



電池如有更換不正確會有爆炸的危險，並請依製造商說明書處理使用過的電池。



避免將電腦放置在磁性物質附近（例如喇叭及電視等）；並請勿將磁片放置在電腦前面及上方，以避免電磁效應造成磁片資料流失。



讓專業人員維修電腦。請勿自行修理本產品，只有合格的專業人員才可以安裝或維修。搭乘飛機時請關機。在飛機上使用電腦會造成儀器的干擾，影響飛行安全，而且也是違法的。



請勿將電腦放置在陽光直接照射的地方，尤其是不不要將電腦留在陽光直射的車子裡。



清潔電腦前請先關機，並移開變壓器及內部電池。



請勿將電腦放置在過冷的環境中（5℃ 或是 41°F 以下），也不要將電腦放在過熱的環境當中（35℃ 或是 95°F 以上），如此可能導致無法正常開機運作。



液晶顯示螢幕表面會因靜電而吸附灰塵，如發現有灰塵時請使用柔軟乾布擦拭，並請勿過度用力擦拭，也請勿用手直接拍除，以免在液晶顯示螢幕表面留下些許指紋。



避免電腦及其配件淋到水或是暴露在溼氣當中。



攜帶 Eee PC 所使用的揹袋必須具備防碰撞的緩衝襯墊，並請勿放置過多物件，以避免壓壞液晶顯示器。

關於這本使用手冊

本手冊包含了所有當您在使用 Eee PC 時所需用到的資訊，以下是本手冊主要的章節介紹。

1. 第一章：認識您的 Eee PC

本章節介紹 Eee PC 的外觀與功能說明，並教您如何安裝電池、接上電源等設定您的電腦。

2. 第二章：開始使用

本章節介紹首次開機以及開機後的基本操作。

3. 附錄



在使用手冊與快速使用指南中所有的圖示僅供參考，請以出貨時的介面圖示為準。

提示符號

為了能夠確保您正確地完成 Eee PC 設定，請務必注意下面這些會在本手冊出現的標示符號所代表的特殊含意。



警告：提醒您在進行某一項工作時要注意您本身的安全。



重要：此符號表示您必須要遵照手冊所描述之方式完成一項或多項軟硬體的安裝或設定。



祕訣：提供有助於完成某項工作的訣竅。



注意：其他額外的資訊。

第 1 章

認識您的 Eee PC

- ◎ 外觀介紹
- ◎ 設定您的電腦
- ◎ 觸控板的使用

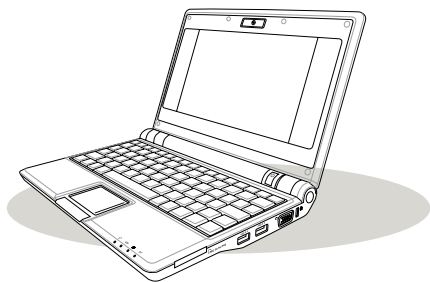

外觀介紹

華碩 Eee PC 是一款操作簡單且輕巧的攜帶型電腦，具備直覺的圖像化介面與完整的無線連網能力，隨時連接上網，輕鬆使用、輕巧上路。以下介紹產品各部位的功能。

上視圖

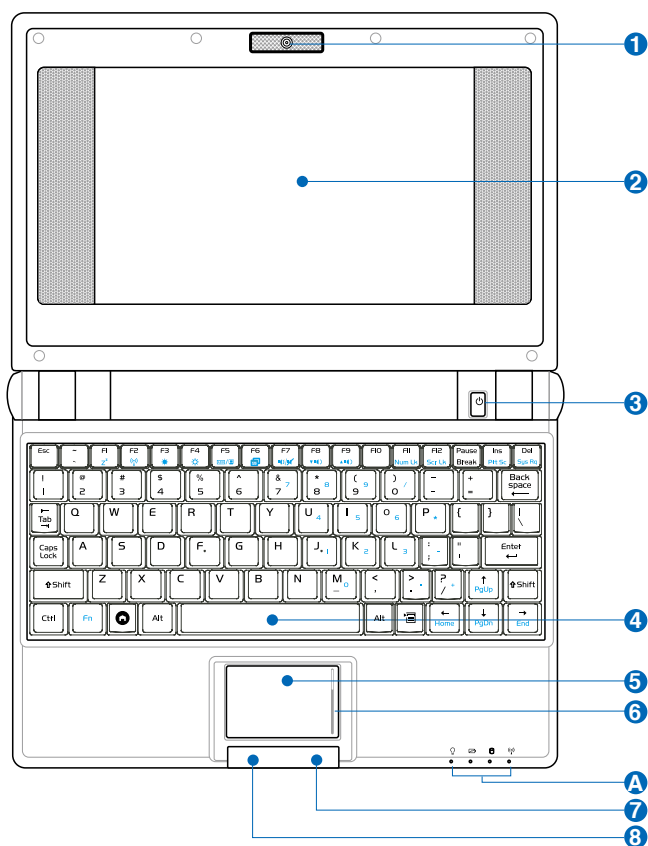

您的 Eee PC 鍵盤可能會因為購買產品的地區或國家而與圖示有所不同。

編號	功能	詳細說明
1	攝影機	可截取動態及靜態影像（選購）
2	彩色液晶螢幕	顯示螢幕
3	電源按鈕	開啟或關閉電腦電源
4	全功能鍵盤組	輸入各項資訊
5	觸控板	用來控制電腦上的游標，和滑鼠功能相同
6	觸控板捲頁功能區	用來控制視窗捲軸功能
7	觸控板右鍵	即滑鼠的右鍵功能
8	觸控板左鍵	即滑鼠的左鍵功能
A	電腦狀態指示燈	<div> <div>💡</div> <div>🔋</div> <div>💾</div> <div>📶</div> </div> 電源指示燈 充電指示燈 固態硬碟存取指示燈 無線網路指示燈

後視圖

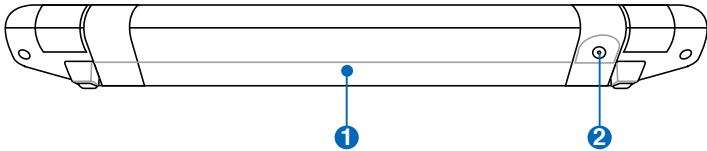

編號	功能	詳細說明
1	電池	可抽換式電池，供給電腦電源
2	電源插孔	連接電源變壓器

底視圖

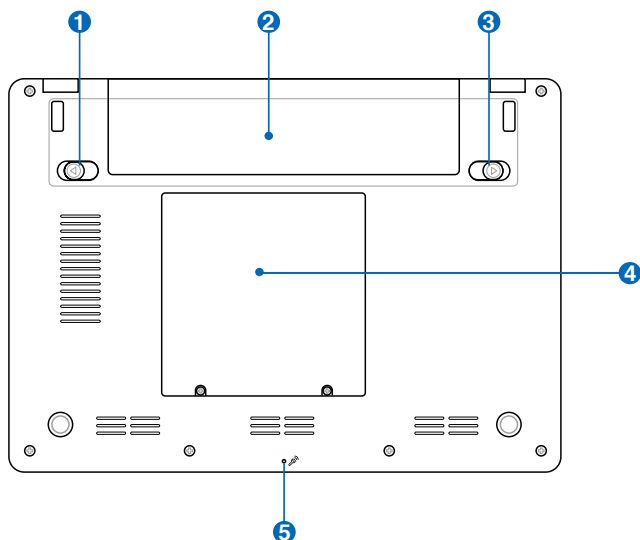

編號	功能	詳細說明
1	電池彈簧開關	向外輕輕一撥即可開鎖
2	充電電池	可抽換式電池，供給電腦電源
3	電池手動開關	向內推為上鎖，向外推為開鎖
4	SSD 固態硬碟保護蓋	硬碟蓋用來保護 SSD 固態硬碟，免於受到外力損害
5	麥克風收音孔	執行收音功能



當電腦正常運作或充電時，會發熱散逸到表面，變壓器在正常使用時仍可能發出高熱，因此請勿將 Eee PC 及變壓器長時間放置在膝上或是身體任一部位，並避免在過於柔軟不平的表面（如床上），或墊有軟質桌墊的桌面上使用。保持散熱孔暢通，以利散熱。

左視圖

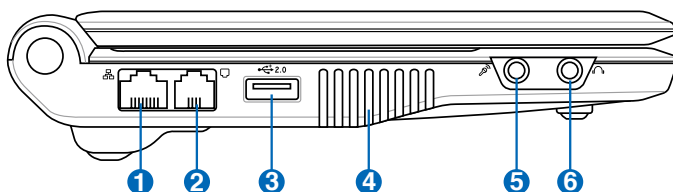

編號	功能	詳細說明
1	網路插孔	RJ-45 網路插孔
2	數據機插孔	連接電話線以撥接方式上網（選購）
3	USB 2.0 埠	連接 USB 外接裝置
4	散熱孔	電腦散熱通風孔
5	麥克風	連接麥克風
6	耳機	連接耳機

右視圖

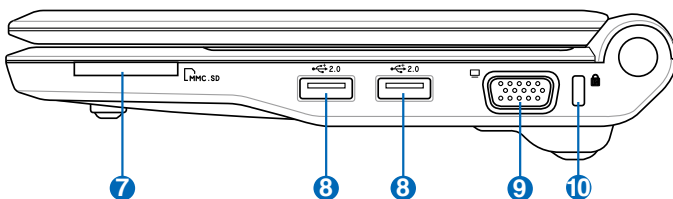

編號	功能	詳細說明
7	多功能讀卡機	支援 MMC 與 SD 記憶卡
8	USB 2.0 埠	連接 USB 外接裝置
9	外接顯示器連接埠	外接顯示螢幕
10	防盜鎖槽	可連接防盜鎖以防止他人竊取

設定您的電腦

電池的安裝與取出

在使用本電腦前，請先安裝電池並接上電源變壓器，Eee PC 的電源供應方式有二種：連接變壓器與電池供應。一般在室內、家裡或辦公室使用時，建議您盡量連接變壓器使用，外出時則使用電池。

安裝電池

1. 將電腦底部朝上，將電池上有黑色凹槽的一面朝向電腦的電池凹槽，沿著電池凹槽的軌道平行緩緩的推入。



電池若是沒有對準凹槽上的軌道會無法順利推入，請重新對準軌道再推入一次，若強行推入可能會造成電池或電腦的毀損。

2. 讓電腦的電池凹槽上金色接腳完全沒入電池上的黑色凹槽，電池推到底後並發出「喀」一聲，電池彈簧開關會自動彈回原位。
3. 再將電池手動開關輕輕往內推來將電池鎖住。

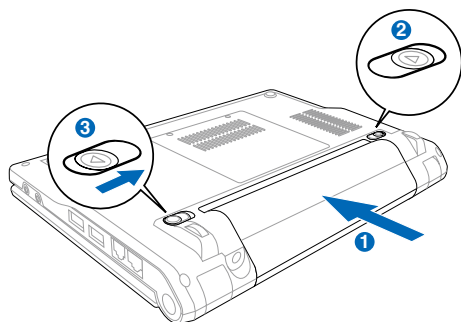

取出電池

1. 將電腦關機，移除所有連接線或裝置。
2. 將電腦的底部朝上，將電池手動開關往外推（如下圖 1）。
3. 將電池彈簧開關往外撥並握住開關（如下圖 2），同時使用另一隻手將電池往外拉出，即可取出電池（如下圖 3）。

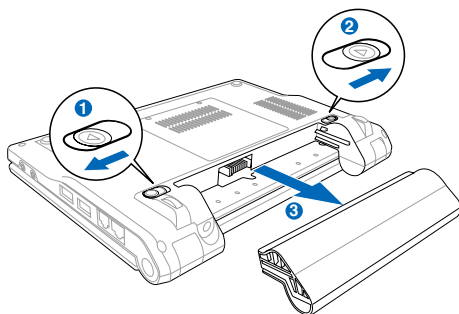

當您的 Eee PC 在開機狀態時，請勿將電池拔除，否則可能會導致硬碟資料毀損。

接上電源

1. 將變壓器圓頭插頭的一端插入電腦後側的充電插孔。
2. 將另一端插入電源插座上。

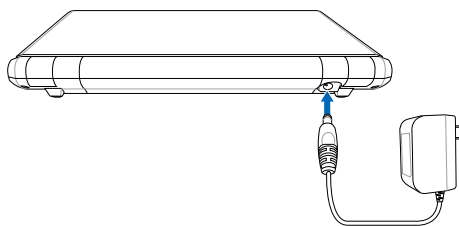

要插入電源插座的電源線接頭會隨著各地區或國家而有不同。您的 Eee PC 貼心的隨貨提供符合購買地區或國家插座規格的轉接頭，請使用該轉接頭來連接電源。本圖示與您包裝盒中的接頭可能不盡相同，僅供參考。

開機

1. 打開您的 Eee PC 螢幕。

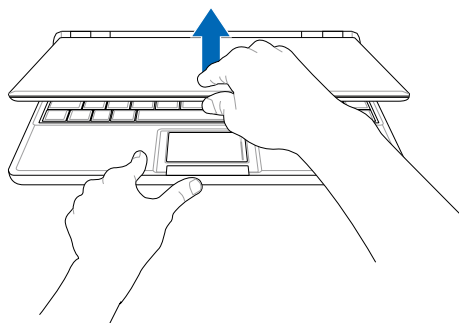

當您將螢幕打開的時候，請不要將螢幕用力往下/往後壓，這麼做可能會導致螢幕與鍵盤中間的轉軸斷裂。此外，要移動您的 Eee PC 時，請勿握住螢幕將電腦拿起。

2. 按下電源按鈕來開機。

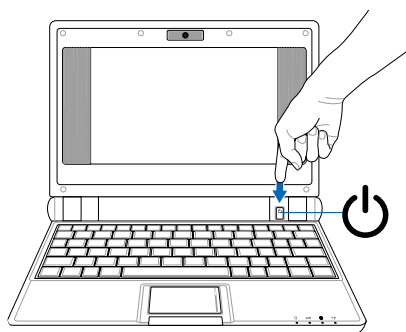

關機

請依照以下步驟來將您的 Eee PC 關機。

1. 點選工作列上的關機圖示 ；
或是點選 **設定** 標籤頁 > **快速關機**；
或直接按下電腦的電源開關。
2. 從彈出式的視窗中點選 **關機**。
3. 點選 **確認** 即可關機。



緊急關機

當您的電腦無法從上述的方法來進行正常的關機或重新開機時，請按住電腦的電源按鈕直到電腦關機為止。

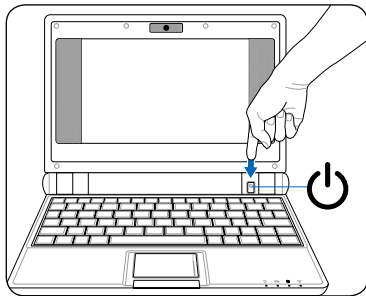

當您的 Eee PC 正在存取或讀寫資料時，請勿使用緊急關機，這麼做可能會導致資料的毀損。

觸控板的使用

1. **觸控板介紹**：觸控板的功能相當於一般電腦的滑鼠，藉由感應手指觸摸板子的壓力，以產生電壓來定位游標與下達指令。

觸控板的工作區域可以感應手指移動，用一隻手指的指腹輕輕觸摸版面，緩緩移動手指即可移動視窗上的游標位置，其下方的按鍵，左邊相當於滑鼠左鍵，可用來點選視窗上的功能或執行程式；右邊相當於滑鼠右鍵。

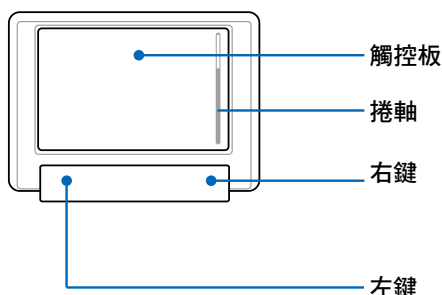

2. **單按/單點**：欲執行視窗某些功能時，手指略微抬起再輕觸一下板子即可，或是按一下板子下方的左鍵，這個動作相當於按一下滑鼠左鍵。

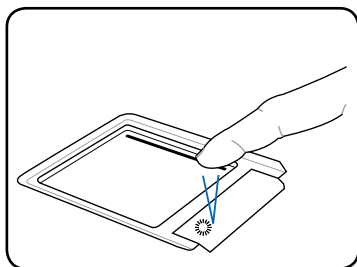
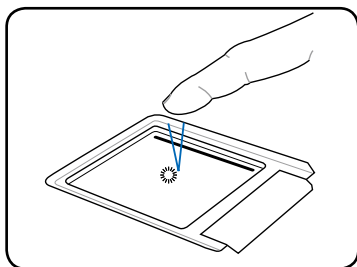

3. **雙按/雙點**：若是想要執行某個應用程式時，將游標移動至該程式的圖示上，快速連續輕觸二下觸控板，或是按二下板子下方的左鍵，這個動作相當於按二下滑鼠左鍵。

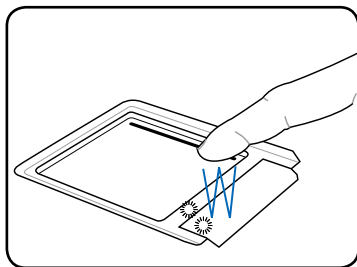
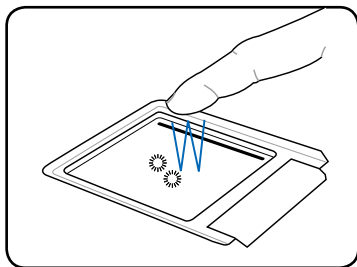

4. **拖曳**：將游標移到想要拖曳的目標上，按住左鍵不放（可用另一隻手指按住左鍵），同時移動游標位置，移到適當位置，放掉左鍵，即可完成拖曳物件。同樣的，您也可以在欲拖曳物件上輕觸兩下觸控板且手指不離開觸控板，即可利用一隻手指的動作將物件直接移到目標位置。

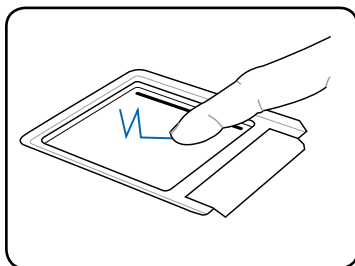
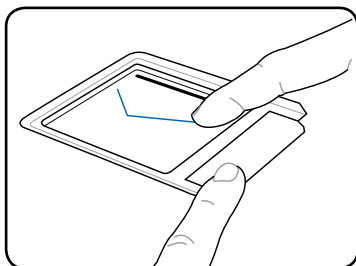

5. **捲軸**：在觸控板右側有一條灰黑色的捲軸圖示，將手指放在此處做上下移動的動作，即可捲動視窗頁面，方便檢視文件及網頁內容。

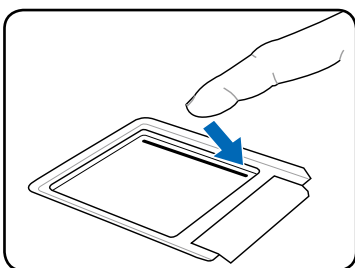
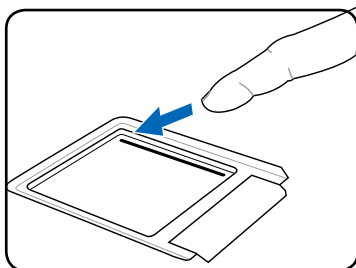

觸控板使用注意事項與保養：

1. 請勿使用尖銳的物品在觸控板上書寫，可能會造成觸控板的損傷。
2. 請避免沾染灰塵、油脂及液體。
3. 使用觸控板時請保持手指清潔乾燥。
4. 不要放置重物在觸控板以及兩個按鍵之上。
5. 本觸控板僅需輕微的觸動即可靈敏感應動作，用力敲擊並不會使觸控板更靈敏順暢，請儘量避免。

第 2 章

開始使用您的 Eee PC

- ◎ 首次開機
- ◎ 鍵盤的使用
- ◎ 桌面模式
- ◎ 輸入法
- ◎ 電源模式

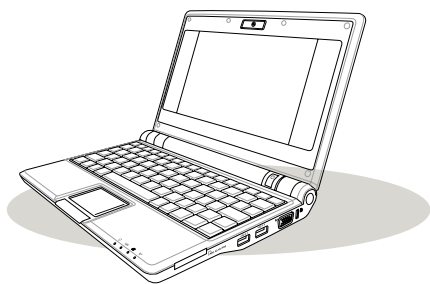

首次開機

當您第一次開始使用 Eee PC 時，開機之後會自動啟動 **首次啟動精靈**，引導您建立個人化設定與輸入一些簡單的基本資料。請依照以下的步驟來完成初始化設定。

1. 第一次開機會出現授權條款版權聲明，點選 **我同意以上授權條款**，然後按 **下一步**。

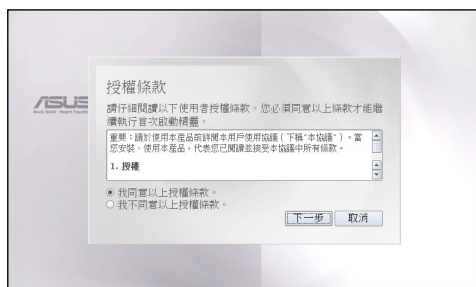

2. 輸入您的使用者名稱。按 **下一步**。



3. 輸入您的密碼，並將該密碼再次輸入作為確認。按 **下一步**。

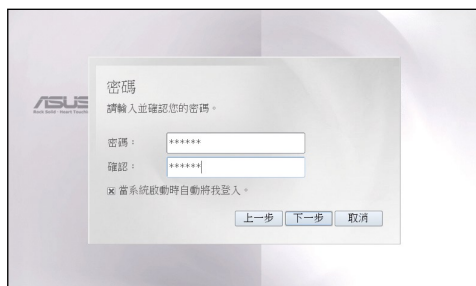

在步驟 3 中您可選擇是否勾選 **當系統啟動時自動將我登入**，若勾選這個選項，每次開機就不需要再輸入密碼確認即可直接進入畫面。若您擔心容易忘記您所設定的密碼，且本機器僅作為個人用途使用，建議您可以勾選本項目。

4. 從下拉式選單選擇時區，輸入日期、當地時間。按**下一步**。





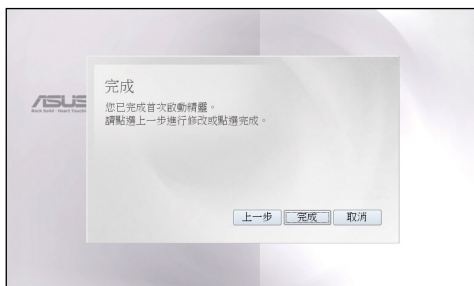















5. 當您完成設定精靈中所有的設定步驟後，按**完成**。若想要變更設定，可以按**上一步**。
6. 電腦會重新自動開機，自動開機後若在步驟 3 沒有勾選自動登入，則此時要先輸入密碼後才能登入。



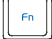

鍵盤的使用

1. 組合按鍵：鍵盤上使用彩色文字或圖像標示部分，是 Eee PC 的功能組合鍵，須同時按住鍵盤左下角的  功能鍵才會發生作用。

組合鍵	功能
 	進入待命模式
 	開啟或關閉內建無線網路功能，當啟動無線網路功能時，電腦右下角的指示燈也會亮起
 	調暗液晶螢幕亮度
 	調亮液晶螢幕亮度
 	切換使用液晶螢幕、外接顯示器或電視來顯示畫面。當您連續按下此二個按鍵時，會依序切換以下三種模式：LCD Only（僅 Eee PC 螢幕顯示）-> CRT Only（僅外接螢幕顯示）-> LCD + CRT Clone（複製模式）。
 	執行工作管理員
 	靜音功能開啟或關閉
 	降低音量
 	提高音量
 	開啟或關閉內建數字鍵盤功能
 	開啟或關閉「鎖定捲頁」功能
 	執行 Print Screen 功能，並會自動彈出「螢幕擷取工具」應用程式
 	上一頁
 	下一頁
 	回到頁首
 	回到頁尾

2. 單一按鍵

按鍵	功能
	基本模式：回到桌面
	按下這個按鍵相當於滑鼠右鍵，可以呼叫右鍵功能表

桌面模式

本產品為您設計貼心的桌面模式，將所有應用程式與相關的功能分為六類，分別放在各個選單中，您可以在桌面上方看到這六個選單標籤，包含有：網際網路、工作、學習、娛樂、設定、我的最愛。這個清楚的桌面分類方式讓初次使用的使用者可以很容易的操作這台電腦，也節省了使用者尋找各項應用程式所在位置的困擾。

將游標移動至選單標籤並在該標籤上用滑鼠左鍵點一下即可進入該選單，在選單中找到想要使用的程式或功能，將游標移動至該圖示，單按或雙按該圖示即可啟動程式或功能。



實際畫面請以所購買的機種為準。

輸入法

當您要書寫或回覆電子郵件，或是在文書處理軟體中需要輸入文字時，可能需要切換使用其他的文字輸入法，請依照下列的方法來進行輸入法的切換。

- 您可以直接點選螢幕下方工作列上的圖示來選擇其他的輸入法。



- 您也可以按下 <Ctrl> + <Space bar>（空白鍵）在中/英文輸入法之間切換。
- 當您切換至中文輸入法時，可以按下 <Ctrl> + <Shift>，依照您的需求選擇想要使用的中文輸入法。

電源模式

您的 Eee PC 配備有聰明的電源模式，在 **Battery Mode（電池模式）** 下，處理器會以較低的頻率運作來降低電力的消耗，可以節省電力的使用，延長電池使用的時間；若在 **AC Mode（電源模式）** 下，處理器會以全速運作，讓您可以獲得最佳的效能表現。

當您接上電源線時，Eee PC 會以 AC Mode（電源模式）運作，當您移除電源線使用電池時，Eee PC 則會以 Battery Mode（電池模式）運作。當您接上或移除電源線時，可以在螢幕上看到如下所示的圖示。

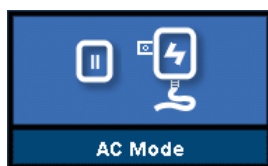

AC Mode（電源模式）



Battery Mode（電池模式）

Super Hybrid Engine 說明

這個內建的 Super Hybrid Engine 可以讓您快速的選用電力運作模式，在不同的電力運作模式下，會影響系統運作的效能，您可以依照您的需求來選擇適合您的操作模式。

在工作列上找到如下圖的圖示，在該圖示上按一下滑鼠右鍵，依照您的需要點選使用的模式，可選用的模式有：Auto、Super Performance、High Performance、Power Saving。

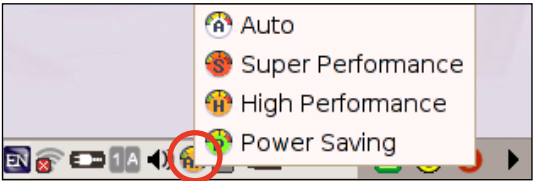

模式名稱	選用模式圖示	選用模式在工作列上的顯示圖示
Super Performance Mode		
High Performance Mode		
Power Saving Mode		
Auto Mode (Auto High-Performance Mode) 說明：只有在接上電源模式的狀態下才會顯示		
Auto Mode (Auto Power-Saving) 說明：只有在電池模式的狀態下才會顯示		

調整視窗位置

當您執行某些應用程式時，該程式的視窗大小若是超過您的電腦螢幕，您可以依照以下的步驟來調整該視窗的位置，以方便您點選超過螢幕之外的按鈕。

1. 按住 <Alt>，然後按住觸控板下方的左鍵，此時滑鼠游標的圖示就會轉變為十字圖示。
2. 使用另一隻手指頭在觸控板上移動，即可將該視窗移動到您想要的位置。

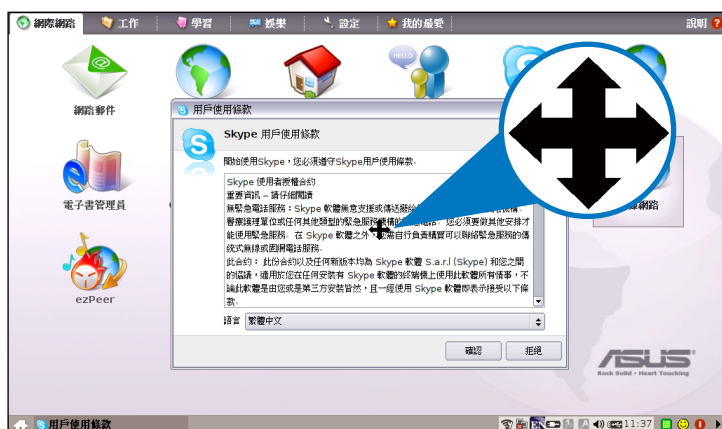
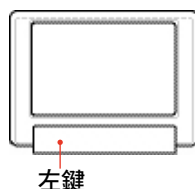

附錄

- ◎ 商標聲明
- ◎ 周邊裝置合格供應商列表
- ◎ GNU General Public License
- ◎ 技術支援與服務

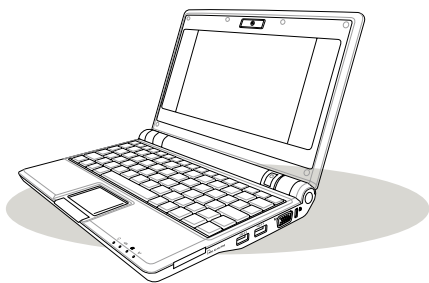

商標聲明

在使用手冊中所談論到的產品名稱或商標符號僅做識別之用，這些名稱可能是屬於其他公司的註冊商標或是版權，在此聲明如下：

- Google Talk 服務與商標是 Google 公司的註冊商標
- GroupWise 服務與商標是 Novell 公司的註冊商標
- MSN 服務與商標是 Microsoft 公司的註冊商標
- QQ 服務與商標是 Tencent 公司的註冊商標
- Yahoo! 服務與商標是 Yahoo! 公司的註冊商標
- 其他未提到的服務與商標，均屬該註冊公司所擁有

周邊裝置合格供應商列表



1. 歡迎您造訪華碩網站查看最新的合格供應商列表。
2. 並非所有的周邊裝置均能在 Eee PC 的 Linux 作業系統上執行，在您購買周邊產品時，請先查看最新的合格供應商列表。

藍牙接收器裝置	
類型	型號
USB1.1	OMIZ Bluetooth V2.0 Dongle
USB2.0	BELKIN F8T012
ODD CD/DVD-ROM/CD-RW/Combo Devices	
類型	型號
USB 2.0	ASUS SCB-2424V-U
	ASUS CB-5216A-U
顯示器	
類型	型號
D-Sub	BenQ FP222W
	DELL 2407WFP
	Philips 107S5
	Acer AL1916W
	ASUS MM17T
	ASUS PM17TU
	ASUS PW191
	ASUS VW192
	ASUS PW201
	BenQ FP<73G>
	BenQ FP783
	LG 1730S
	LG M198WA
	Maya NFS-70
	Samsung 930B
	Samsung 206BW
	Samsung SyncMaster 710T
	Samsung SyncMaster 740BF
	Sony SDM--HS75P
	ViewSonic VE710b
	ViewSonic VX724
	ViewSonic VX2235wm
	ASUS PG191
	ASUS MB19TU
	Great Wall 2172
	MGA GA780K
	TCL LW98

周邊裝置合格供應商列表

ODD DVD-R/DVD-RW/DVD+-RW Devices	
類型	型號
USB 2.0	ASUS DRW-1608P2S-D
	ASUS SDRW-0804P-D
	ASUS SDRW-0806T-D
	BenQ EW164B-0K2
	BenQ TW200D
	Pioneer DVR-112CH
	Sony DRX-S50U
	Sony DRX-820UL
	Teclast DWB8PUM
	Xbox HD DVD
Fast Ethernet Unmanaged Switch/Hub Adapter	
類型	型號
Hub	Alpha AFH-805T
	TP-Link TL-HP5MU
Switch	ASUS GIGAX1105N
	ASUS GIGAX1108N
	NETGEAR FS608
Router	D-Link DI-704P
	Netcore 615GR
Flash Memory Card Reader/Writer	
類型	型號
USB 2.0	ASIA All in1 Card Reader
	GL816 6in1 Card Reader
	Kawau Card Reader
	SSK All in 1 Card Reader
Flash 記憶卡	
類型	型號
SD/MMC	Transcend TS2GSDC 4.0G
	Adata TurboSD2.0 4.0G
	KingSton SD 1.0G
	KingSton SD 2.0G
	KingSton SD 4.0G
	Toshiba SD 256MB
	Panasonic SD 16MB
	SanDisk SD 1.0G
Flash 記憶卡	
類型	型號
	SanDisk SD 4.0G
	Transcend SDHC 8.0G
	ATP SDHC 8.0G
	PNY SDHC 8.0G
	Adata MMC 512MB
	Canon SD 16MB

周邊裝置合格供應商列表

軟碟機	
類型	型號
USB 1.1	Mitsumi D353FUE
	IBM CN533
鍵盤	
類型	型號
USB 1.1	Dell SK-8115
	Denq Q300
	Apple A1048
	Logitech Y-UG75
	Logitech-Y-UR83
	Microsoft Natural Keyboard Pro
	Microsoft Office Keyboard
	Win2 V-810S
	LG ST510U
鍵盤與滑鼠裝置	
類型	型號
Wireless	Logitech MX3200-LASTER
滑鼠	
類型	型號
USB 1.1	Logitech UAG96B
	Microsoft 1004
	Microsoft Basic Optical Mouse
	ASUS M-UV94
	Razer Copperhead Laser Mouse
	Benq I-100
滑鼠	
類型	型號
Wireless	Logitech V200 Optical
	Logitech MX-REVOLUTION
	Microsoft MSK-1056
	Microsoft PRESENTER 3000
Bluetooth	Microsoft MOUSE-8000
M.O. Devices	
類型	型號
USB 2.0	Fujitsu FN640 Slimmate MO USB 2.0
	Fujitsu MDK3064UA
印表機	
類型	型號
USB 1.1	HP Deskjet 1180c
	HP Photosmart 7960
	EPSON STYLUS-C43UX

周邊裝置合格供應商列表

USB 2.0	HP Photosmart D5168
	Epson Stylus photo R800
Removable H.D.D	
類型	型號
USB 2.0	BenQ DP303
	King Apple
	Mobil BOX
	Newman NM-3000
	Newman NW USB2006
	Seagate 4ME0FTCP
	Zynet D2-U2FW
USB Flash Disk	
類型	型號
USB1.1	ASUS AI-Flash 2
USB 2.0	UNIS USB2.0 1G
	Adata 2.0G
	Adata 4.0G
	PQI 4.0G
	KingSton 1.0G
	KingSton 2.0G
	SanDisk 2.0G
USB Flash Disk	
類型	型號
USB 2.0	ASUS Ai-flash 5
	Apacer Handy AH320 8.0G
	Teclast Coolflash 8.0G
	TOSHIBA-256M
	SanDisk Cruiser contour 2.0G
	Adata 8.0G
	Lenovo USB Flash
USB HUB Devices	
類型	型號
USB 2.0	BELKIN F5U237
	FEATARES-USB2.0 HUB
無線網路接入點	
類型	型號
Normal	TP Link TL-WR841N
	ASUS WL 500g
	ASUS WL 520g
	ASUS WL 566GM
	ASUS WL 530g
	D-Link DI 624
	D-Link DIR-635
	Linksys WRT300N

Federal Communications Commission Statement

This device complies with FCC Rules Part 15. Operation is subject to the following two conditions:

- This device may not cause harmful interference, and
- This device must accept any interference received, including interference that may cause undesired operation.

This equipment has been tested and found to comply with the limits for a class B digital device, pursuant to Part 15 of the Federal Communications Commission (FCC) rules. These limits are designed to provide reasonable protection against harmful interference in a residential installation. This equipment generates, uses, and can radiate radio frequency energy and, if not installed and used in accordance with the instructions, may cause harmful interference to radio communications. However, there is no guarantee that interference will not occur in a particular installation. If this equipment does cause harmful interference to radio or television reception, which can be determined by turning the equipment off and on, the user is encouraged to try to correct the interference by one or more of the following measures:

- Reorient or relocate the receiving antenna.
- Increase the separation between the equipment and receiver.
- Connect the equipment into an outlet on a circuit different from that to which the receiver is connected.
- Consult the dealer or an experienced radio/TV technician for help.



The use of a shielded-type power cord is required in order to meet FCC emission limits and to prevent interference to the nearby radio and television reception. It is essential that only the supplied power cord be used. Use only shielded cables to connect I/O devices to this equipment. You are cautioned that changes or modifications not expressly approved by the party responsible for compliance could void your authority to operate the equipment.

(Reprinted from the Code of Federal Regulations #47, part 15.193, 1993. Washington DC: Office of the Federal Register, National Archives and Records Administration, U.S. Government Printing Office.)

FCC Radio Frequency (RF) Exposure Caution Statement



Any changes or modifications not expressly approved by the party responsible for compliance could void the user's authority to operate this equipment. "The manufacture declares that this device is limited to Channels 1 through 11 in the 2.4GHz frequency by specified firmware controlled in the USA."

This equipment complies with FCC radiation exposure limits set forth for an uncontrolled environment. To maintain compliance with FCC RF exposure compliance requirements, please avoid direct contact to the transmitting antenna during transmitting. End users must follow the specific operating instructions for satisfying RF exposure compliance.

Max. SAR Measurement (1g)

802.11b SAR Value: 0.097 W/kg

802.11g SAR Value: 0.062 W/kg

GNU General Public License

Licensing Information

This product includes copyrighted third-party software licensed under the terms of the GNU General Public License. See The GNU General Public License for the exact terms and conditions of this license. Specially, the following parts of this product are subject to the GNU GPL:

- The Linux operating system kernel
- Firefox
- Kworldclock
- Pidgin
- KCal
- Kontact
- KSnapshot
- Thunderbird
- Knotes
- Kalzium
- Kstars
- Tux Typing
- KMessedWords
- KHangMan
- Kbruch
- Freemind
- Stellarium
- Tux, of Math Command
- Kig
- KmPlot
- mtPaint
- Tux Paint
- KPatience
- Frozen Bubble
- Crack Attack
- GNOME Sudoku
- KTuberling
- LTris
- The KControl Xprinters Module
- The KControl Clock Module
- GSynaptics
- Gcompris
- Enigma
- Supertux
- Boswars
- Xmahjongg
- Tuxpuck

All listed software packages are copyright by their respective authors. Refer to the source code for detailed information.

ASUSTeK COMPUTER Inc. has exposed the full source code of the GPL licensed software, including any scripts to control compilation and installation of the object code. All future firmware updates will also be accompanied with their respective source code. For more information on how you can obtain our open source code, visit our website (<http://support.asus.com.tw/download/>).

GNU GENERAL PUBLIC LICENSE

Version 2, June 1991

Copyright (C) 1989, 1991 Free Software Foundation, Inc.,
51 Franklin Street, Fifth Floor, Boston, MA 02110-1301 USA

Everyone is permitted to copy and distribute verbatim copies of this license document, but changing it is not allowed.

Preamble

The licenses for most software are designed to take away your freedom to share and change it. By contrast, the GNU General Public License is intended to guarantee your freedom to share and change free software--to make sure the software is free for all its users. This General Public License applies to most of the Free Software Foundation's software and to any other program whose authors commit to using it. (Some other Free Software Foundation software is covered by the GNU Lesser General Public License instead.) You can apply it to your programs, too.

When we speak of free software, we are referring to freedom, not price. Our General Public Licenses are designed to make sure that you have the freedom to distribute copies of free software (and charge for this service if you wish), that you receive source code or can get it if you want it, that you can change the software or use pieces of it in new free programs; and that you know you can do these things.

To protect your rights, we need to make restrictions that forbid anyone to deny you these rights or to ask you to surrender the rights. These restrictions translate to certain responsibilities for you if you distribute copies of the software, or if you modify it.

For example, if you distribute copies of such a program, whether gratis or for a fee, you must give the recipients all the rights that you have. You must make sure that they, too, receive or can get the source code. And you must show them these terms so they know their rights.

We protect your rights with two steps: (1) copyright the software, and (2) offer you this license which gives you legal permission to copy, distribute and/or modify the software.

Also, for each author's protection and ours, we want to make certain that everyone understands that there is no warranty for this free software. If the software is modified by someone else and passed on, we want its recipients to know that what they have is not the original, so that any problems introduced by others will not reflect on the original authors' reputations.

Finally, any free program is threatened constantly by software patents. We wish to avoid the danger that redistributors of a free program will individually obtain patent licenses, in effect making the program proprietary. To prevent this, we have made it clear that any patent must be licensed for everyone's free use or not licensed at all.

The precise terms and conditions for copying, distribution and modification follow.

TERMS AND CONDITIONS FOR COPYING, DISTRIBUTION AND MODIFICATION

0. This License applies to any program or other work which contains a notice placed by the copyright holder saying it may be distributed under the terms of this General Public License. The "Program", below, refers to any such program or work, and a "work based on the Program" means either the Program or any derivative work under copyright law: that is to say, a work containing the Program or a portion of it, either verbatim or with modifications and/or translated into another language. (Hereinafter, translation is included without limitation in the term "modification".) Each licensee is addressed as "you".

Activities other than copying, distribution and modification are not covered by this License; they are outside its scope. The act of running the Program is not restricted, and the output from the Program is covered only if its contents constitute a work based on the Program (independent of having been made by running the Program). Whether that is true depends on what the Program does.

1. You may copy and distribute verbatim copies of the Program's source code as you receive it, in any medium, provided that you conspicuously and appropriately publish on each copy an appropriate copyright notice and disclaimer of warranty; keep intact all the notices that refer to this License and to the absence of any warranty; and give any other recipients of the Program a copy of this License along with the Program.

You may charge a fee for the physical act of transferring a copy, and you may at your option offer warranty protection in exchange for a fee.

2. You may modify your copy or copies of the Program or any portion of it, thus forming a work based on the Program, and copy and distribute such modifications or work under the terms of Section 1 above, provided that you also meet all of these conditions:

- a) You must cause the modified files to carry prominent notices stating that you changed the files and the date of any change.
- b) You must cause any work that you distribute or publish, that in whole or in part contains or is derived from the Program or any part thereof, to be licensed as a whole at no charge to all third parties under the terms of this License.
- c) If the modified program normally reads commands interactively when run, you must cause it, when started running for such interactive use in the most ordinary way, to print or display an announcement including an appropriate copyright notice and a notice that there is no warranty (or else, saying that you provide a warranty) and that users may redistribute the program under these conditions, and telling the user how to view a copy of this License. (Exception: if the Program itself is interactive but does not normally print such an announcement, your work based on the Program is not required to print an announcement.)

These requirements apply to the modified work as a whole. If identifiable sections of that work are not derived from the Program, and can be reasonably considered independent and separate works in themselves, then this License, and its terms, do not apply to those sections when you distribute them as separate works. But when you distribute the same sections as part of a whole which is a work based on the Program, the distribution of the whole must be on the terms of this License, whose permissions for other licensees extend to the entire whole, and thus to each and every part regardless of who wrote it.

Thus, it is not the intent of this section to claim rights or contest your rights to work written entirely by you; rather, the intent is to exercise the right to control the distribution of derivative or collective works based on the Program.

In addition, mere aggregation of another work not based on the Program with the Program (or with a work based on the Program) on a volume of a storage or distribution medium does not bring the other work under the scope of this License.

3. You may copy and distribute the Program (or a work based on it, under Section 2) in object code or executable form under the terms of Sections 1 and 2 above provided that you also do one of the following:

- a) Accompany it with the complete corresponding machine-readable source code, which must be distributed under the terms of Sections 1 and 2 above on a medium customarily used for software interchange; or,
- b) Accompany it with a written offer, valid for at least three years, to give any third party, for a charge no more than your cost of physically performing source distribution, a complete machine-readable copy of the corresponding source code, to be distributed under the terms of Sections 1 and 2 above on a medium customarily used for software interchange; or,

- c) Accompany it with the information you received as to the offer to distribute corresponding source code. (This alternative is allowed only for noncommercial distribution and only if you received the program in object code or executable form with such an offer, in accord with Subsection b above.)

The source code for a work means the preferred form of the work for making modifications to it. For an executable work, complete source code means all the source code for all modules it contains, plus any associated interface definition files, plus the scripts used to control compilation and installation of the executable. However, as a special exception, the source code distributed need not include anything that is normally distributed (in either source or binary form) with the major components (compiler, kernel, and so on) of the operating system on which the executable runs, unless that component itself accompanies the executable.

If distribution of executable or object code is made by offering access to copy from a designated place, then offering equivalent access to copy the source code from the same place counts as distribution of the source code, even though third parties are not compelled to copy the source along with the object code.

4. You may not copy, modify, sublicense, or distribute the Program except as expressly provided under this License. Any attempt otherwise to copy, modify, sublicense or distribute the Program is void, and will automatically terminate your rights under this License. However, parties who have received copies, or rights, from you under this License will not have their licenses terminated so long as such parties remain in full compliance.

5. You are not required to accept this License, since you have not signed it. However, nothing else grants you permission to modify or distribute the Program or its derivative works. These actions are prohibited by law if you do not accept this License. Therefore, by modifying or distributing the Program (or any work based on the Program), you indicate your acceptance of this License to do so, and all its terms and conditions for copying, distributing or modifying the Program or works based on it.

6. Each time you redistribute the Program (or any work based on the Program), the recipient automatically receives a license from the original licensor to copy, distribute or modify the Program subject to these terms and conditions. You may not impose any further restrictions on the recipients' exercise of the rights granted herein. You are not responsible for enforcing compliance by third parties to this License.

7. If, as a consequence of a court judgment or allegation of patent infringement or for any other reason (not limited to patent issues), conditions are imposed on you (whether by court order, agreement or otherwise) that contradict the conditions of this License, they do not excuse you from the conditions of this License. If you cannot distribute so as to satisfy simultaneously your obligations under this License and any other pertinent obligations, then as a consequence you may not distribute the Program at all. For example, if a patent license would not permit royalty-free redistribution of the Program by all those who receive copies directly or indirectly through you, then the only way you could satisfy both it and this License would be to refrain entirely from distribution of the Program.

If any portion of this section is held invalid or unenforceable under any particular circumstance, the balance of the section is intended to apply and the section as a whole is intended to apply in other circumstances.

It is not the purpose of this section to induce you to infringe any patents or other property right claims or to contest validity of any such claims; this section has the sole purpose of protecting the integrity of the free software distribution system, which is implemented by public license practices. Many people have made generous contributions to the wide range of software distributed through that system in reliance on consistent application of that system; it is up to the author/donor to decide if he or she is willing to distribute software through any other system and a licensee cannot impose that choice.

This section is intended to make thoroughly clear what is believed to be a consequence of the rest of this License.

8. If the distribution and/or use of the Program is restricted in certain countries either by patents or by copyrighted interfaces, the original copyright holder who places the Program under this License may add an explicit geographical distribution limitation excluding those countries, so that distribution is permitted only in or among countries not thus excluded. In such case, this License incorporates the limitation as if written in the body of this License.

9. The Free Software Foundation may publish revised and/or new versions of the General Public License from time to time. Such new versions will be similar in spirit to the present version, but may differ in detail to address new problems or concerns.

Each version is given a distinguishing version number. If the Program specifies a version number of this License which applies to it and "any later version", you have the option of following the terms and conditions either of that version or of any later version published by the Free Software Foundation. If the Program does not specify a version number of this License, you may choose any version ever published by the Free Software Foundation.

10. If you wish to incorporate parts of the Program into other free programs whose distribution conditions are different, write to the author to ask for permission. For software which is copyrighted by the Free Software Foundation, write to the Free Software Foundation; we sometimes make exceptions for this. Our decision will be guided by the two goals of preserving the free status of all derivatives of our free software and of promoting the sharing and reuse of software generally.

NO WARRANTY

11. BECAUSE THE PROGRAM IS LICENSED FREE OF CHARGE, THERE IS NO WARRANTY FOR THE PROGRAM, TO THE EXTENT PERMITTED BY APPLICABLE LAW. EXCEPT WHEN OTHERWISE STATED IN WRITING THE COPYRIGHT HOLDERS AND/OR OTHER PARTIES PROVIDE THE PROGRAM "AS IS" WITHOUT WARRANTY OF ANY KIND, EITHER EXPRESSED OR IMPLIED, INCLUDING, BUT NOT LIMITED TO, THE IMPLIED WARRANTIES OF MERCHANTABILITY AND FITNESS FOR A PARTICULAR PURPOSE. THE ENTIRE RISK AS TO THE QUALITY AND PERFORMANCE OF THE PROGRAM IS WITH YOU. SHOULD THE PROGRAM PROVE DEFECTIVE, YOU ASSUME THE COST OF ALL NECESSARY SERVICING, REPAIR OR CORRECTION.

12. IN NO EVENT UNLESS REQUIRED BY APPLICABLE LAW OR AGREED TO IN WRITING WILL ANY COPYRIGHT HOLDER, OR ANY OTHER PARTY WHO MAY MODIFY AND/OR REDISTRIBUTE THE PROGRAM AS PERMITTED ABOVE, BE LIABLE TO YOU FOR DAMAGES, INCLUDING ANY GENERAL, SPECIAL, INCIDENTAL OR CONSEQUENTIAL DAMAGES ARISING OUT OF THE USE OR INABILITY TO USE THE PROGRAM (INCLUDING BUT NOT LIMITED TO LOSS OF DATA OR DATA BEING RENDERED INACCURATE OR LOSSES SUSTAINED BY YOU OR THIRD PARTIES OR A FAILURE OF THE PROGRAM TO OPERATE WITH ANY OTHER PROGRAMS), EVEN IF SUCH HOLDER OR OTHER PARTY HAS BEEN ADVISED OF THE POSSIBILITY OF SUCH DAMAGES.

END OF TERMS AND CONDITIONS

How to Apply These Terms to Your New Programs

If you develop a new program, and you want it to be of the greatest possible use to the public, the best way to achieve this is to make it free software which everyone can redistribute and change under these terms.

To do so, attach the following notices to the program. It is safest to attach them to the start of each source file to most effectively convey the exclusion of warranty; and each file should have at least the "copyright" line and a pointer to where the full notice is found.

<one line to give the program's name and a brief idea of what it does.> Copyright (C) <year> <name of author>

This program is free software; you can redistribute it and/or modify it under the terms of the GNU General Public License as published by the Free Software Foundation; either version 2 of the License, or (at your option) any later version.

This program is distributed in the hope that it will be useful, but WITHOUT ANY WARRANTY; without even the implied warranty of MERCHANTABILITY or FITNESS FOR A PARTICULAR PURPOSE. See the GNU General Public License for more details.

You should have received a copy of the GNU General Public License along with this program; if not, write to the Free Software Foundation, Inc., 51 Franklin Street, Fifth Floor, Boston, MA 02110-1301 USA.

Also add information on how to contact you by electronic and paper mail.

If the program is interactive, make it output a short notice like this when it starts in an interactive mode:

Gnomovision version 69, Copyright (C) year name of author
Gnomovision comes with ABSOLUTELY NO WARRANTY; for details
type `show w'. This is free software, and you are welcome to
redistribute it under certain conditions; type `show c' for details.

The hypothetical commands ``show w'` and ``show c'` should show the appropriate parts of the General Public License. Of course, the commands you use may be called something other than ``show w'` and ``show c'`; they could even be mouse-clicks or menu items--whatever suits your program.

You should also get your employer (if you work as a programmer) or your school, if any, to sign a "copyright disclaimer" for the program, if necessary. Here is a sample; alter the names:

Yoyodyne, Inc., hereby disclaims all copyright interest in the program ``Gnomovision'` (which makes passes at compilers) written by James Hacker.

<signature of Ty Coon>, 1 April 1989

Ty Coon, President of Vice

This General Public License does not permit incorporating your program into proprietary programs. If your program is a subroutine library, you may consider it more useful to permit linking proprietary applications with the library. If this is what you want to do, use the GNU Lesser General Public License instead of this License.

技術支援與服務

若您需要任何技術支援與服務，請造訪華碩網站 <http://support.asus.com.tw>。

[illegible]

[illegible]

[illegible]