

C4227

Eee PC 易电脑用户手册

Eee PC 900HA Series

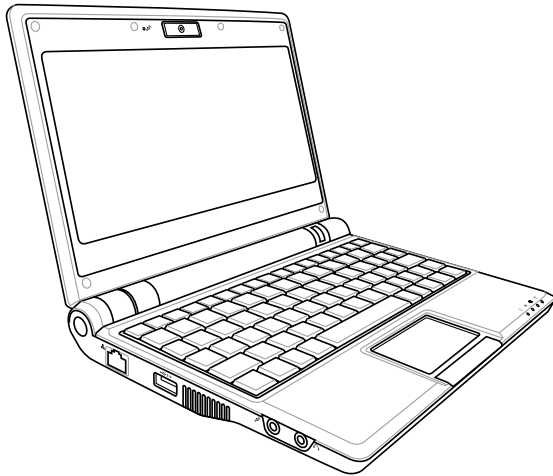

版权说明

版权所有·不得翻印 ©2008 华硕电脑

本用户手册包括但不限于其所包含的所有信息受到著作权法之保护，未经华硕电脑股份有限公司（以下简称「华硕」）许可，不得任意地仿制、拷贝、誊抄、转译或为其他使用或处分。

免责声明

本用户手册没有任何型式的担保、立场表达或其它暗示。若有任何因本用户手册或其所提到之产品的所有信息，所引起直接或间接的数据流失、利益损失或事业终止，华硕及其所属员工恕不为其担负任何责任。除此之外，本用户手册所提到的产品规格及信息仅供参考，内容亦会随时升级，恕不另行通知。华硕不负责本用户手册的任何错误或疏失。

本用户手册中所提及的产品名称仅供做为识别之用，而前述名称可能是属于其他公司的注册商标或是著作权。

当下列两种情况发生时，本产品将不再受到华硕公司之保修及服务：

- (1) 该产品曾经非华硕授权之维修、规格更改、零件替换。
- (2) 产品序列号模糊不清或丧失。

产品规格或驱动程序改变，用户手册都会随之升级。升级的详细说明请您访问华硕的客户服务网 <http://support.asus.com.cn>。

目录

目录	3
安全说明	5
关于这本用户手册	6
提示符号	6

第 1 章 认识您的易电脑

外观介绍	10
上视图	10
后视图	11
底视图	12
左视图	13
右视图	13
设置您的电脑	14
电池的安装与取出	14
接上电源	15
启动	16
关机	17
紧急关机与重置启动	17
触摸板的使用	18
触摸板介绍	18
单手指操作说明	18
多手指操作说明	19

第 2 章 开始使用您的易电脑

首次启动	22
键盘的使用	24
桌面模式	25
输入法	26

目录

第 3 章 系统还原

使用隐藏分区还原 Linux 系统.....	28
使用还原光盘还原 Linux 系统.....	29
使用 U 盘还原 Linux 系统.....	30
将 U 盘重新格式化.....	33
Boot Booster.....	34

第 4 章 安装 Windows XP

安装 Windows® XP 事前准备事项.....	36
安装 Windows® XP.....	36
驱动程序光盘信息.....	38
运行驱动程序光盘.....	38
驱动程序菜单.....	39
应用程序菜单.....	39
华硕的联络信息.....	39
其他信息.....	39

附录

商标声明.....	42
外围设备合格供应商列表.....	43
GNU General Public License.....	52
技术支持与服务.....	64

安全说明

在您使用本产品之前，请先详细阅读以下指引的使用原则，并遵守这些规则，可以增加产品的使用寿命，并可以避免发生危险或触犯法律。



请勿用手触摸或按压显示器，如此将可能造成显示器损坏。



请勿将电池存放靠近火源或是丢入燃烧的火堆中，有可能造成爆炸的意外，请支持回收废弃电池。



避免在灰尘飞扬或是环境脏乱的场所使用电脑（灰尘容易引起系统故障）。



使用合格的电池与配件。仅供使用原厂认可或推荐的电池与配件，请勿使用其他类别或不知是否相容产品或配件，否则可能会损坏电脑。



请勿将电脑放在重心不稳的物品上。



请勿放置重物在电脑上，电脑上面亦不可以堆迭书本纸张等物品，亦请勿用力盖上液晶显示屏上盖，避免液晶显示屏损坏。



让专业人员维修电脑。请勿自行修理本产品，只有合格的专业人员才可以安装或维修。搭乘飞机时请关机。在飞机上使用电脑会造成仪器的干扰，影响飞行安全，而且也是违法的。



避免将电脑放置在磁性物质附近（例如喇叭及电视等）；并请勿将软盘放置在电脑前面及上方，以避免电磁效应造成软盘数据流失。



清洁电脑前请先关机，并移开电源适配器及内部电池。



请勿将电脑放置在阳光直接照射的地方，尤其是不要将电脑留在阳光直射的车子里。



液晶显示屏表面会因静电而吸附灰尘，如发现有灰尘时请使用柔软干布擦拭，并请勿过度用力擦拭，也请勿用手直接拍除，以免在液晶显示屏表面留下些许指纹。



请勿将电脑放置在过冷的环境中（5℃ 或是 30°F 以下），也不要将电脑放在过热的环境当中（50℃ 或是 122°F 以上），如此可能导致无法正常启动运作。



携带易电脑所使用的背袋必须具备防碰撞的缓冲衬垫，并请勿放置过多物件，以避免压坏液晶显示器。



避免电脑及其配件淋到水或是暴露在湿气当中。



电池如有更换不正确会有爆炸的危险，并请依照制造商说明书处理使用过的电池。

关于这本用户手册

本手册包含了所有当您在使用易电脑时所需用到的信息，以下是本手册主要的各章节介绍。

1. 第一章：认识您的易电脑

本章节介绍易电脑的外观与功能说明，并教您如何安装电池、接上电源等设置您的电脑。

2. 第二章：开始使用

本章节介绍首次启动以及启动后的基本操作。

3. 第三章：操作您的易电脑

本章节介绍如何使用易电脑内置的程序。

4. 第四章：驱动程序光盘与系统还原

本章节介绍随货附赠的驱动程序光盘的使用方法与内容，以及如何操作系统还原功能。

5. 第五章：附录



在用户手册中所有的屏幕图标仅供参考，请以出货时的实际内容为准。

提示符号

为了能够确保您正确地完成易电脑设置，请务必注意下面这些会在本手册出现的标示符号所代表的特殊含意。



警告：提醒您在进行某一项工作时要注意您本身的安全。



重要：此符号表示您必须要遵照手册所描述之方式完成一项或多项软硬件的安装或设置。



秘诀：提供有助于完成某项工作的诀窍。



注意：其他额外的信息。



电子信息产品污染控制标示：图中之数字为产品之环保使用期限。仅指电子信息产品中含有的有毒有害物质或元素不致发生外泄或突变从而对环境造成污染或对人身、财产造成严重损害的期限。

有毒有害物质或元素的名称及含量说明标示：

部件名称	有害物质或元素					
	铅 (Pb)	汞 (Hg)	镉 (Cd)	六价铬 (Cr(VI))	多溴联苯 (PBB)	多溴二苯醚 (PBDE)
印刷电路板及其电子组件	×	○	○	○	○	○
硬盘	×	○	○	○	○	○
光驱	×	○	○	○	○	○
液晶屏	×	○	×	○	○	○
外壳	×	○	○	○	○	○
键盘	×	○	○	○	○	○
电源适配器	×	○	○	○	○	○
外部信号连接头及线材	×	○	○	○	○	○
中央处理器与内容	×	○	○	○	○	○
触摸板	×	○	○	○	○	○
喇叭	×	○	○	○	○	○
鼠标	×	○	○	○	○	○
电池	×	○	○	○	○	○

○：表示该有毒有害物质在该部件所有均质材料中的含量均在 SJ/T 11363-2006 标准规定的限量要求以下。

×

表示该有毒有害物质至少在该部件的某一均质材料中的含量超出 SJ/T 11363-2006 标准规定的限量要求，然该部件仍符合欧盟指令 2002/95/EC 的规范。

备注：此产品所标示之环保使用期限，系指在一般正常使用状况下。

[illegible]

第 1 章

认识您的易电脑

- ◎ 外观介绍
- ◎ 设置您的电脑
- ◎ 触摸板的使用

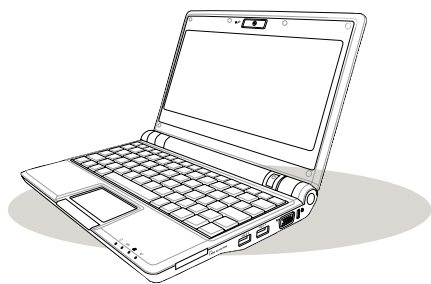

外观介绍

华硕 EeePC 是一款操作简单且轻巧的携带型电脑，具备直观的图像化界面与完整的无线连网能力，随时连接上网，轻松使用、轻巧上路。以下介绍产品各部位的功能。

上视图

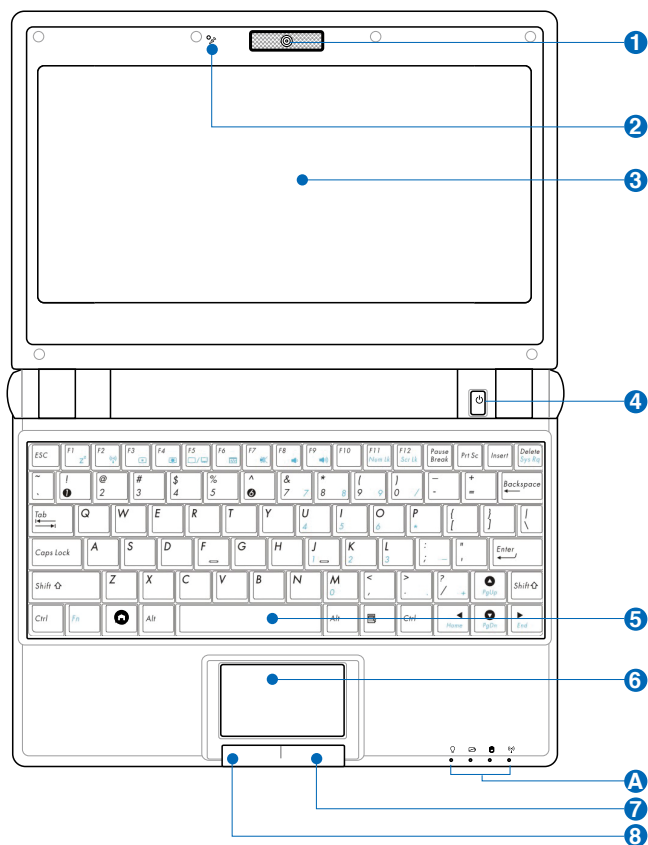

您的易电脑键盘可能会因为购买产品的地区或国家而与图标有所不同。

编号	功能	详细说明
1	摄像头	可截取动态及静态影像
2	麦克风收音孔	用于收音功能
3	彩色液晶屏幕	显示屏
4	电源按钮	开启或关闭电脑电源
5	全功能键盘组	输入各项信息
6	触摸板	用来控制电脑上的光标，和鼠标功能相同
7	触摸板右键	即鼠标的右键功能
8	触摸板左键	即鼠标的左键功能
A	电脑状态指示灯	<ul style="list-style-type: none"> 💡 电源指示灯 🔌 充电指示灯 💿 硬盘存取指示灯 📶 无线网络指示灯

后视图

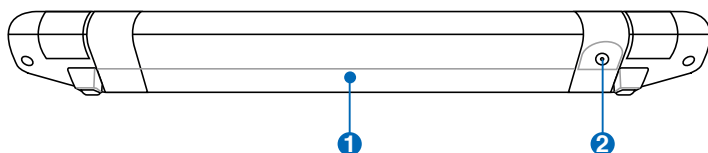

编号	功能	详细说明
1	电池	可抽换式电池，供给电脑电源
2	电源插孔	连接电源适配器

底视图

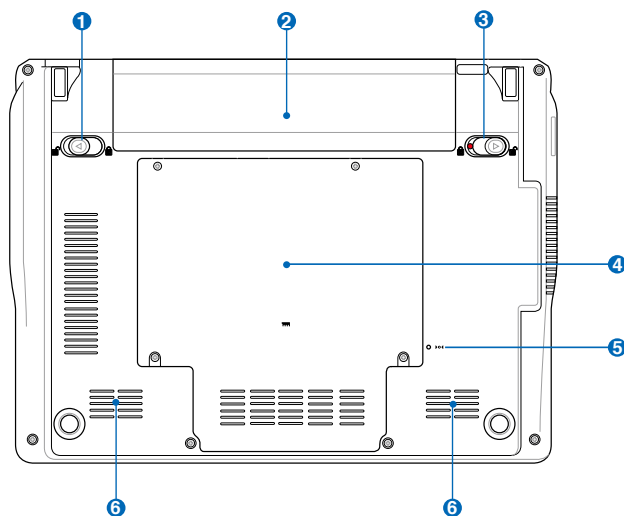

编号	功能	详细说明
1	电池弹簧开关	向外轻轻一拨即可开锁
2	充电电池	可抽换式电池，供给电脑电源
3	电池手动开关	向内推为上锁，向外推为开锁
4	硬盘保护盖	保护盖用来保护硬盘，免于受到外力损害
5	重置启动孔 (Reset)	当电脑无法正常关机或重新启动时，请使用细直的回形针插入本孔来重新启动
6	喇叭	用于播音功能



当电脑正常运作或充电时，会发热散逸到表面，电源适配器在正常使用时仍可能发出高热，因此请勿将易电脑及电源适配器长时间放置在膝上或是身体任一部位，并避免在过于柔软不平的表面（如床上），或垫有软质桌垫的桌面上使用。保持散热孔畅通，以利散热。

左视图

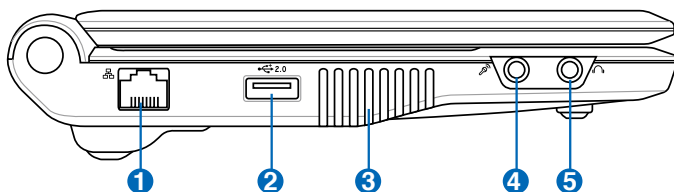

编号	功能	详细说明
1	网络插孔	RJ-45 网络插孔
2	USB 2.0 端口	连接 USB 外接设备
3	散热孔	电脑散热通风孔
4	麦克风接口	连接外置麦克风
5	耳机接口	连接耳机

右视图

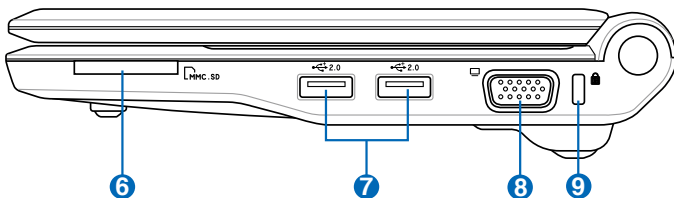

编号	功能	详细说明
6	多功能读卡器	支持 MMC 与 SD 存储卡
7	USB 2.0 端口	连接 USB 外接设备
8	外接显示器连接端口	外接显示屏
9	防盗锁槽	可连接防盗锁以防止他人窃取

设置您的电脑

电池的安装与取出

在使用本电脑前，请先安装电池并接上电源，**易电脑的电源供应方式有二种：连接电源适配器与电池供应。**一般在室内、家里或办公室使用时，建议您尽量连接电源适配器使用，外出时则使用电池。

安装电池

1. 将电脑底部朝上，将电池上有黑色凹槽的一面朝向电脑的电池凹槽，沿着电池凹槽的轨道平行缓缓的推入。



电池若是没有对准凹槽上的轨道会无法顺利推入，请重新对准轨道再推入一次，若强行推入可能会造成电池或电脑的毁损。

2. 让电脑的电池凹槽上金色接脚完全没入电池上的黑色凹槽，电池推到底后并发出「喀」一声，电池弹簧开关会自动弹回原位。
3. 再将电池手动开关轻轻往内推来将电池锁住。

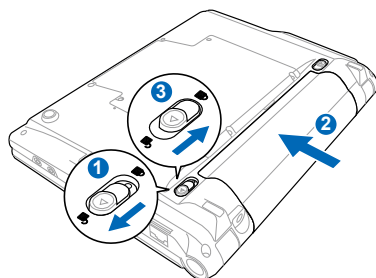

全新的电池包在出厂都有部份些许余量的电能，我们推荐您在使用前先行安装电池并对其接上电源适配器进行充电，在经过数次之完全充电及耗尽电池电能的反反复复使用后，电池的性能会发挥到最佳的状态。第一次使用前，请务必充电满八小时。

取出电池

1. 将电脑关机，去除所有连接线或设备。
2. 将电脑的底部朝上，将电池手动开关往外推（如下图 1）。
3. 将电池弹簧开关往外拨并握住开关（如下图 2），同时使用另一只手将电池往外拉出，即可取出电池（如下图 3）。

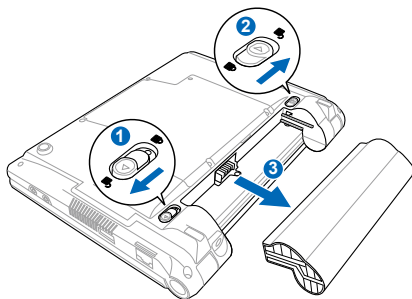

当您的易电脑在启动状态时，请勿将电池拔除，否则可能会导致硬盘数据毁损。

接上电源

1. 将电源适配器与交流电源插头的电源线连接起来。
2. 将交流电源插头接到插座上。
3. 将电源适配器上的圆形插头插入电脑后侧的充电插孔。

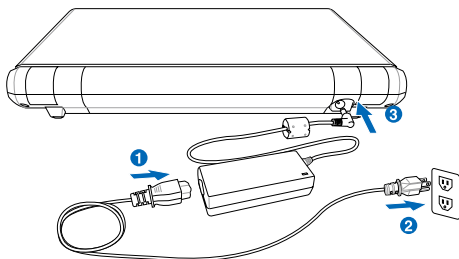

- 请使用易电脑专用的电源适配器。本机台适用输入 +12Vdc, 3A 的电源规格。
- 要插入电源插座的电源线接口会随着各地区或国家而有不同。您的易电脑贴心的随货提供符合购买地区或国家插座规格的电源线插头，请使用该电源线来连接电源适配器与电源。本图与您包装盒中的接口可能不尽相同，仅供参考。

启动

1. 打开您的易电脑屏幕。

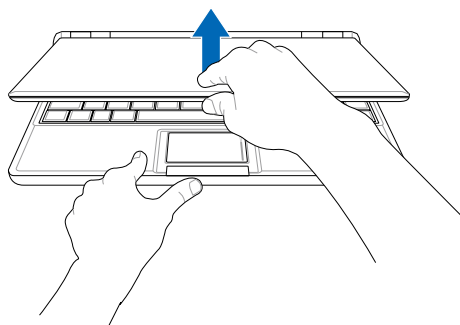

当您将屏幕打开的时候，请不要将屏幕用力往下/往后压，这么做可能会导致屏幕与键盘中间的转轴断裂。此外，要移动您的易电脑时，请勿握住屏幕将电脑拿起。

2. 按下电源按钮来启动。

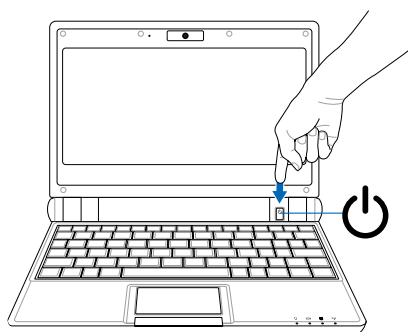

关机

请依照以下步骤来将您的易电脑关机。

1. 点击任务栏上的关机图标 ；
或是点击 设置 标签页 > 快速关机；
或直接按下电脑的电源开关。
2. 从弹出的窗口中点击 关机。
3. 点击 确定 即可关机。



紧急关机与重置启动

当您的电脑无法从上述的方法来进行正常的关机或重新启动时，请参考以下的方法来将您的易电脑关机或重新启动。

紧急关机

按住电脑的电源按钮直到电脑关机为止。

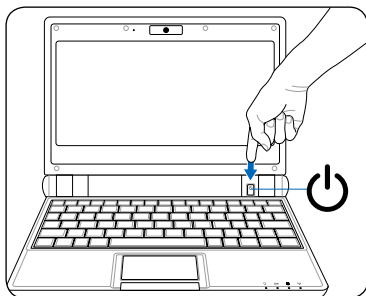

重置启动

使用细直的回形针插入电脑底部的重新启动孔  来重置启动。

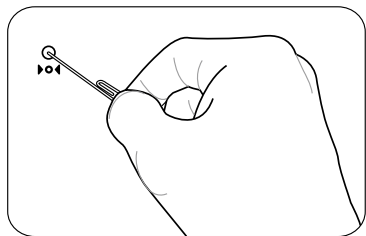

当您的易电脑正在存取或读写数据时，请勿使用紧急关机或重置启动，这么做可能会导致数据的毁损。

触摸板的使用

触摸板介绍

触摸板的功能相当于一般电脑的鼠标，借由感应手指触摸板面的压力，以产生电压来定位光标与下达指令。

触摸板的工作区域可以感应手指移动，用一只手指的指腹轻轻触摸板面，缓缓移动手指即可移动窗口上的光标位置，其下方的按键，左边相当于鼠标左键，可用来点击窗口上的功能或运行程序；右边相当于鼠标右键。

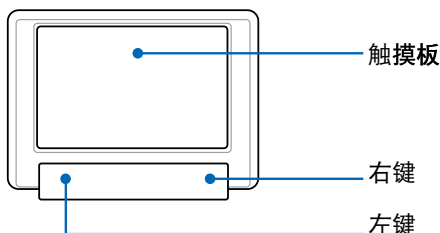

单手指操作说明

1. 单击/单点：欲运行窗口某些功能时，手指略微抬起再轻触一下板面即可，或是按一下触摸板下方的左键，这个动作相当于按一下鼠标左键。

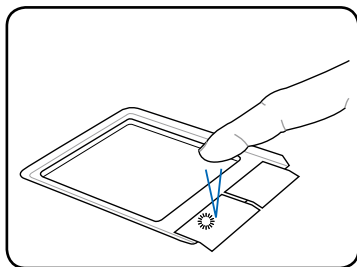
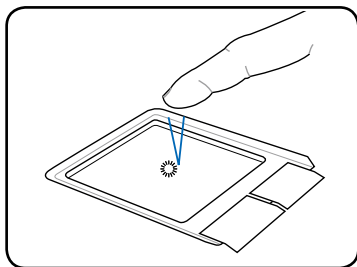

触摸板使用注意事项与保养：

1. 请勿使用尖锐的物品在触摸板上书写，可能会造成触摸板的损伤。
2. 请避免沾染灰尘、油脂及液体。
3. 使用触摸板时请保持手指清洁干燥。
4. 不要放置重物在触摸板以及两个按键之上。
5. 本触摸板仅需轻微的触动即可灵敏感应动作，用力敲击并不会使触摸板更灵敏顺畅，请尽量避免。

2. 双击/双点：若是想要运行某个应用程序时，将光标移动至该程序的图标上，快速连续轻触二下触摸板，或是按二下板面下方的左键，这个动作相当于按下鼠标左键。

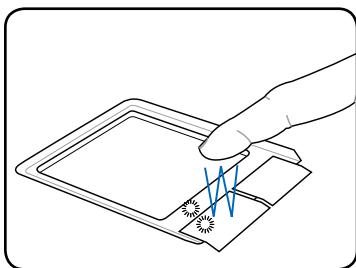
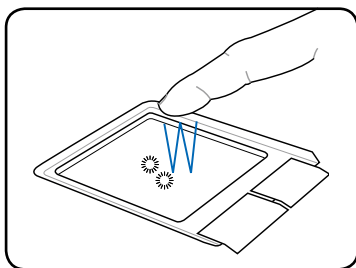

4. 拖曳：将光标移到想要拖曳的目标上，按住左键不放（可用另一只手指按住左键），同时移动光标位置，移到适当位置，放掉左键，即可完成拖曳物件。同样的，您也可以在欲拖曳物件上轻触两下触摸板且手指不离开触摸板，即可利用一只手指的动作将物件直接移到目标位置。

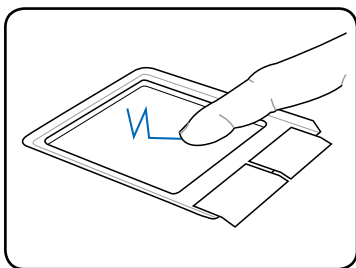
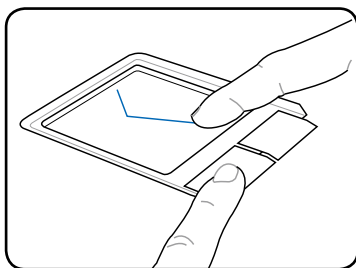

多手指操作说明

1. 二只手指卷动（Scroll）：将二只手指合并一起做往上/往下推或往左/往右推的动作，即可将页面或文件往上/往下或往左/往右卷动。

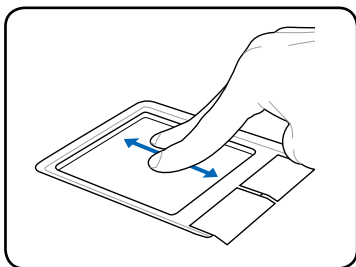

第 2 章

开始使用您的易电脑

- ◎ 首次启动
- ◎ 键盘的使用
- ◎ 桌面模式
- ◎ 输入法

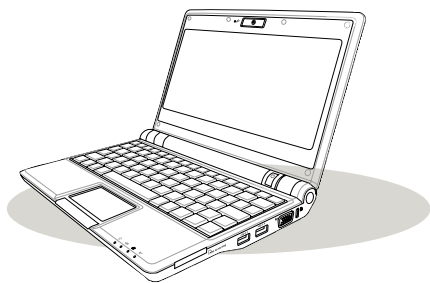

首次启动

当您第一次开始使用易电脑时，启动之后会自动运行「首次启动向导」，引导您建立个人化设置与输入一些简单的基本数据。请依照以下的步骤来完成初始化设置。

1. 第一次启动会出现许可协议，点击 **我接受此协议**，然后按 **下一步**。

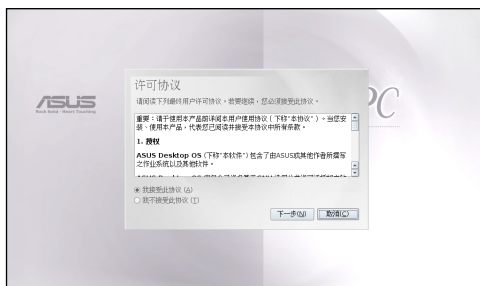

2. 输入您的用户名称。按 **下一步**。

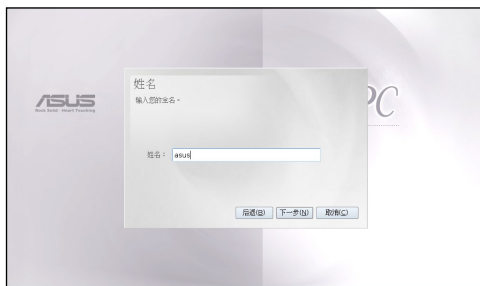

3. 输入您的密码，并将该密码再次输入作为确认。按 **下一步**。

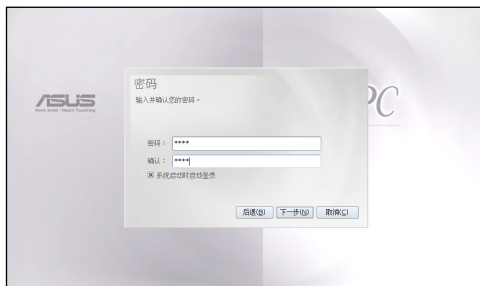

在步骤 3 中您可选择是否勾选 **系统开启时自动登录**，若勾选这个选项，每次启动就不需要再输入密码确认即可直接进入画面。若您担心容易忘记您所设置的密码，且本机器仅作为个人用途使用，建议您可以勾选本项目。

4. 从下拉式菜单选择时区，输入日期、当地时间。按 下一步。



5. 当您完成设置向导中所有的设置步骤后，按 完成。若想要变更设置，可以按 后退。
6. 电脑会重新自动启动，自动启动后若在步骤 3 没有勾选自动登入，则此时要先输入密码后才能登入。





键盘的使用

1. 组合按键：键盘上使用彩色文字或图像标示部分，是易电脑的功能组合键，须同时按住键盘左下角的  功能键才会发生作用。

组合键	功能
 	进入待机模式
 	开启或关闭内建无线网络功能，当启动无线网络功能时，电脑右下角的指示灯也会亮起
 	调暗液晶屏幕亮度
 	调亮液晶屏幕亮度
 	切换使用液晶屏幕、外接显示器或电视来显示画面。
 	运行任务管理器
 	静音功能开启或关闭
 	降低音量
 	提高音量
 	开启或关闭内置数字键盘功能
 	开启或关闭「锁定卷页」功能
 	运行 Print Screen 功能，并会自动弹出「屏幕截图工具」应用程序
 	上一页
 	下一页
 	回到页首
 	回到页尾

2. 单一按键

按键	功能
	回到桌面
	按下这个按键相当于鼠标右键，可以打开右键功能表

桌面模式

本产品为您设计贴心的桌面模式，将所有应用程序与相关的功能分为六类，分别放在各个菜单中，您可以在桌面上方看到这六个菜单标签，包含有：互联网、工作、学习、娱乐、设置、收藏夹。这个清楚的桌面分类方式让初次使用的用户可以很容易的操作这台电脑，也节省了用户寻找各项应用程序所在位置的困扰。

将光标移动至菜单标签，点击想要使用的标签即可进入该菜单，在菜单中找到想要使用的程序或功能，将光标移动至该图标，单击或双击该图标即可启动程序或功能。



桌面模式的内容可能与本图示不完全相同，仅供参考，请以您所购买的产品版本为准。

输入法

当您书写或回复电子邮件，或是在文档处理软件中需要输入文字时，可能需要切换使用其他的文字输入法，请依照下列的方法来进行输入法的切换。

- 您可以直接点击屏幕下方任务栏上的键盘图标来选择其他的输入法。



- 您也可以按下 <Ctrl> + <Space bar>（空白键）在中/英文输入法之间切换。
- 当您切换至中文输入法时，可以按下 <Ctrl> + <Shift>，依照您的需求选择想要使用的中文输入法。

第 3 章

系统还原

- ◎ 使用隐藏分区还原 Linux 系统
- ◎ 使用还原光盘还原 Linux 系统
- ◎ 使用 U 盘还原 Linux 系统
- ◎ 将 U 盘重新格式化
- ◎ Boot Booster

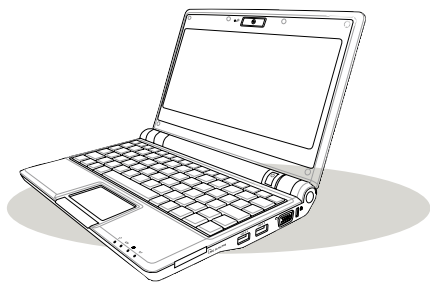

本产品提供三种方式让您运行系统还原功能，请参考下列的详细说明。



在驱动程序光盘中的操作系统镜像文件可能不是最新的版本，在您运行系统还原之后，请使用 设置 标签页的 添加/删除程序 来升级您的系统。



进行系统还原之前，请先将硬盘中的数据进行备份，因为硬盘中的数据将会全部被删除。

使用隐藏分区还原 Linux 系统

1. 将易电脑启动，在启动时按住 <F9>（需要拥有还原磁区）。



若您已经将易电脑的操作系统改装为 Windows XP，则内置的隐藏分区会被删除，无法用来运行系统还原功能。

2. 选择 Restore Factory Settings 然后按下 <Enter> 即可开始进行系统还原。

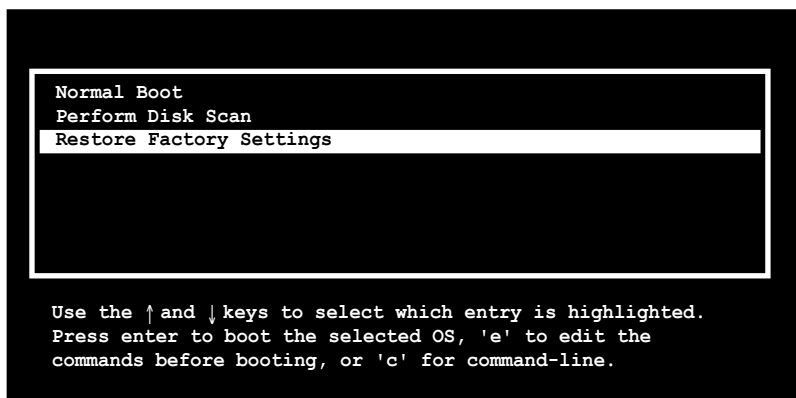

3. 输入 yes 后按下 <Enter> 来继续运行系统还原的动作。
4. 接着会出现运行还原动作将删除硬盘中的数据，请您确认已经将数据进行备份的确认讯息，输入 yes 后按下 <Enter> 继续进行还原的动作。
5. 当系统还原完成时，按下 <Enter> 来重新启动。

使用还原光盘还原 Linux 系统

1. 将外接式光驱连接至电脑的 USB 连接端口，然后将还原光盘放入光驱中。
2. 将易电脑启动，在启动过程中按下 <ESC> 会出现 Please select boot device 菜单，选择 USB:xxxxxx (光驱名称会依您所连接的机种不同而异) 将光驱设定为启动设备，接着请依照屏幕的指示来进行安装的流程。

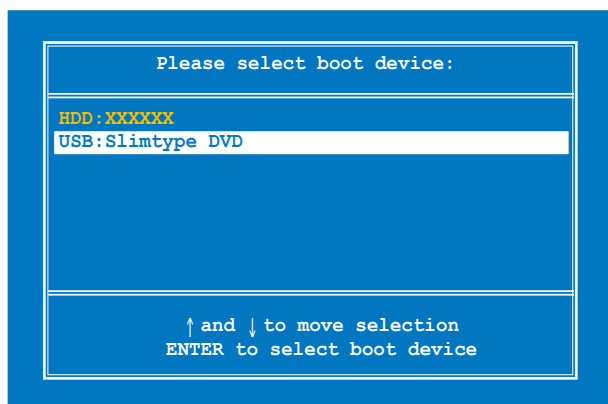

3. 输入 yes 后按下 <Enter> 来继续运行系统还原的动作。

```
ISOLINUX 3.11 2005-09-02 Copyright (C) 1994-2005 H. Peter Anvin
.

Press <Space> for Troubleshooting Menu...
Loading /boot/vmlinuz.....
Loading /boot/initrd.gz.....
Ready.
Uncompressing Linux... Ok, booting the kernel.
Waiting 5 Sec

Ready to image Eee PC using build 2008.04.21_16.24.
Enter "yes" to continue, anything else to reboot.
yes
```

4. 当出现 Format partition? [yes/NO] 信息时，请依照您的需求，输入 yes 将硬盘格式化；或输入 NO 选择不格式化硬盘。
5. 当系统还原完成时，按下 <Enter> 来重新启动。

使用 U 盘还原 Linux 系统

您需要使用另一台电脑与一个容量至少 1GB 的 U 盘来协助您运行系统还原。



在将 U 盘作为电脑的启动磁盘之前，请先将 U 盘中的数据进行备份，因为 U 盘中的数据将会全部被删除。

请依照以下步骤通过 U 盘运行系统还原。

1. 将容量至少 1GB 的 U 盘插入另一台电脑或笔记本电脑（内置 Windows XP 或更新的操作系统），然后将 Support CD 光盘放入电脑或笔记本电脑的光驱中。
2. 在左侧点击 应用程序 菜单，然后选择 华硕 Linux USB Flash 工具程序。



3. 选择 拷贝 Eee PC 影像文件至 U 盘且可用来启动。

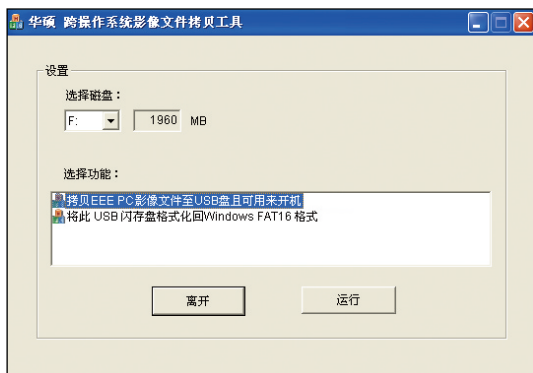

若是您在另一台电脑或笔记本电脑上插有数个 U 盘，请将要运行易电脑系统还原的 U 盘标上标示以避免混淆。

4. 退出光驱中的 Support DVD 光盘，放入 Linux 操作系统还原光盘，然后点击 运行。
5. 在确认对话框中点击 是，系统会开始将您的 U 盘进行格式化。

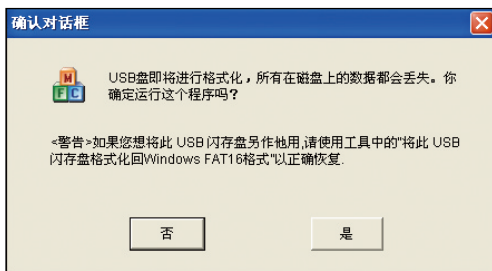

6. 接着会再出现一个确认的对话框，请依照对话框中的指示，将 U 盘拔出再插入电脑或笔记本电脑上，然后再按下 重试 按钮。

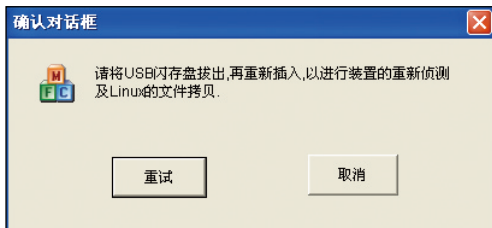

7. 点击 确定 完成将 U 盘制作为启动磁盘的动作。
8. 将 U 盘插入您的易电脑。
9. 将易电脑重新启动，在启动过程中按下 <ESC> 会出现 Please select boot device 菜单，选择 USB:xxxxxx (U 盘名称会依您所连接的机种不同而异) 将 U 盘设定为启动设备，接着请依照屏幕的指示来进行安装的流程。

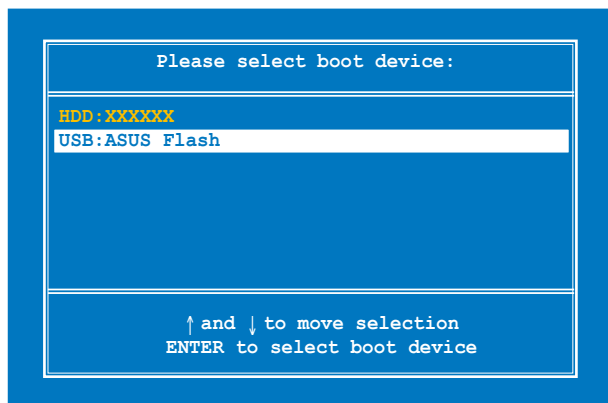

10. 输入 yes 后按下 <Enter> 来继续运行系统还原的动作。

```
ISOLINUX 3.11 2005-09-02 Copyright (C) 1994-2005 H. Peter Anvin
.

Press <Space> for Troubleshooting Menu...
Loading /boot/vmlinuz.....
Loading /boot/initrd.gz.....
Ready.
Uncompressing Linux... Ok, booting the kernel.
Waiting 5 Sec

Ready to image Eee PC using build 2008.1.22_17.21.
Enter "yes" to continue, anything else to reboot.
yes
```

11. 当出现 Format partition? [yes/NO] 信息时，请依照您的需求，输入 yes 将硬盘格式化；或输入 NO 选择不格式化硬盘。
12. 当系统还原完成时，按下 <Enter> 来重新启动。

将 U 盘重新格式化

完成易电脑的系统还原之后，若是这个 U 盘要在 Windows 操作系统下使用，您必须先依照以下步骤将这个 U 盘重新格式化之后才能在 Windows 操作系统下使用。

1. 将 U 盘插入另一台电脑或笔记本电脑，然后将驱动程序 DVD 光盘放入电脑或笔记本电脑的光驱中。
2. 在左侧点击 应用程序 菜单，然后选择 华硕 Linux USB Flash 工具程序。
3. 选择 将此 U 盘格式化回 Windows FAT16 格式，然后点击 运行。

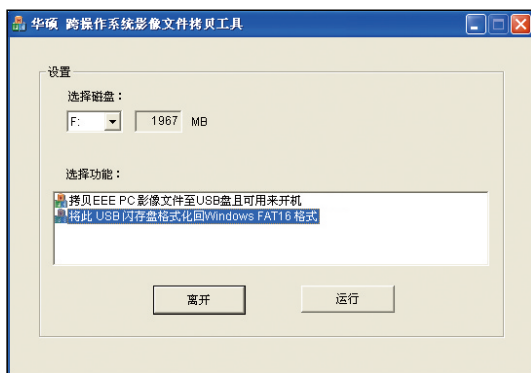

4. 点击 确定 来完成格式化。



Boot Booster

在 BIOS 程序中的 Boot Booster 项目，可以帮助您缩短易电脑的启动时间，但是您必须在对易电脑进行任何更改之前、或在运行系统还原之前（不论是透过 U 盘、外接式光驱，或是隐藏磁盘进行还原），进入 BIOS 程序将这个项目设置为 [Disabled]。请依照以下步骤关闭 Boot Booster 功能：

1. 启动电脑，请在一秒内按下 <F2> 键进入自我检测（POST），然后再按一次 <F2> 键进入 BIOS 程序。



若是您在运行上述动作之后没有进入自我检测（POST），或是没有进入 BIOS 程序，请重新启动电脑，并在启动过程中连续按下 <F2> 按键。

2. 将 Boot Booster 设置为 [Disabled]。

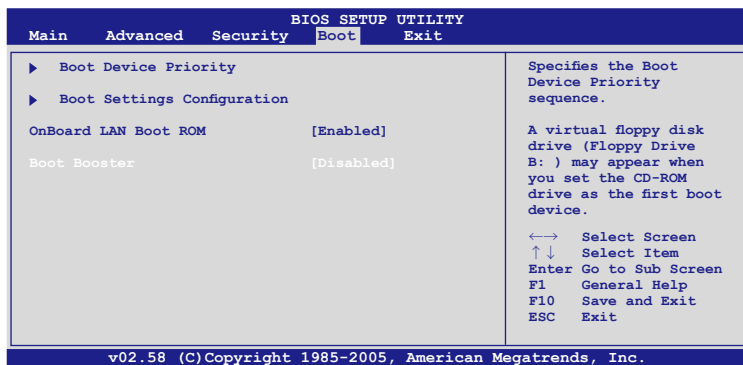

3. 按下 <F10> 键保存更改设置并离开 BIOS 程序，重新启动电脑。



在您完成对易电脑的更改或系统还原之后，请记得将 Boot Booster 设置为 [Enabled]。

第 4 章

安装 Windows XP

- ◎ 安装 Windows XP 事前准备事项
- ◎ 安装 Windows XP
- ◎ 驱动程序光盘信息

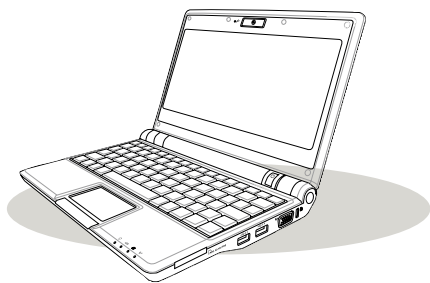

安装 Windows® XP 事前准备事项

在将您的易电脑安装 Windows XP 操作系统之前，您需要先准备好以下列出的项目。

- 一台 USB 2.0 DVD 驱动器。
- Windows XP Service Pack 2 正式版安装光盘。
- 易电脑驱动程序光盘。



早期的 Windows XP 安装光盘不支持使用 USB DVD 驱动器，因此，请确认您要安装的操作系统为 Windows XP Service Pack 2。

安装 Windows® XP

请依照以下步骤安装 Windows® XP Service Pack 2 操作系统。

1. 将您的易电脑接上电源线，防止在安装过程中电力突然中断。
2. 将 USB 光驱连接到易电脑的 USB 连接端口，然后将 Windows XP Service Pack 2 光盘放入 USB DVD 驱动器。
3. 将易电脑启动，在启动后屏幕出现 ASUS Eee PC 字样时，按下按键 <ESC>。
4. 接着会出现如下图所示的 Please select boot device screen 菜单，选择 USB:xxxxxx (光驱名称会依机种不同而异) 将光驱设置为启动设备。

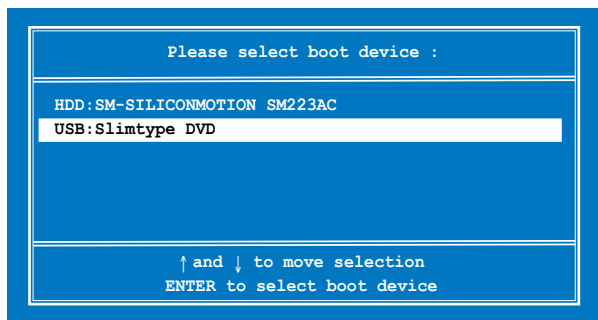

5. 在 Windows XP 安装程序画面时，删除所有的磁盘分区。



删除磁盘分区时，所有的数据都会遗失，请确认在安装 Windows XP 操作系统之前，已经将您的数据进行备份。

6. 按下 <Enter> 然后选择 Format the partition using the NTFS file system 来进行格式化与 Windows® XP 操作系统的安装设置。
7. 接着依照屏幕上的指示来完成操作系统的安装程序。
8. 将系统重新启动，进入 Windows® 操作系统后，将驱动程序光盘放入 USB DVD 驱动器，然后点选 ASUS InstAll - 驱动程序安装向导 来安装所有的驱动程序。



Windows® XP 操作系统的安装可能需要一些时间，请耐心等待。

驱动程序光盘信息

随货附赠的驱动程序 DVD 光盘中包含有驱动程序、应用程序等，您可以安装这些程序和软件来加强您的易电脑的功能。



1. 驱动程序光盘中的内容可能会不定时升级，恕不另行通知。请访问华硕网站（www.asus.com.cn）来获得最新的信息。
2. 本手册的驱动程序光盘的画面仅出现在 Windows XP Service Pack2 操作系统，若您所使用的操作系统不是 Windows XP Service Pack2，则画面可能不完全相同。

运行驱动程序光盘

将驱动程序光盘放入外接式的光驱，若您的系统已启动「自动播放」功能，光盘会自动运行并显示驱动程序菜单。

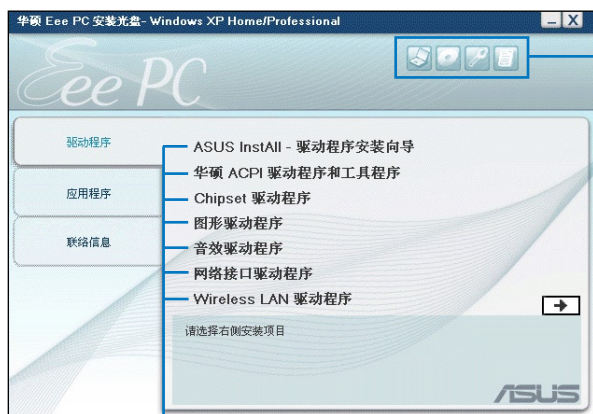

点击图标来获得更多关于驱动程序光盘与易电脑的数据

点击安装各项驱动程序



如果光盘的驱动程序菜单没有自动出现，您可以到光盘的 BIN 文件夹中直接点击 ASSETUP.EXE 来开启菜单窗口。

驱动程序菜单

在驱动程序菜单中会依照系统侦测到有安装的硬件设备来显示可使用的驱动程序。安装需要的驱动程序来启动该设备。

应用程序菜单

在应用程序菜单中会列出所有可以在易电脑上使用的应用程序和其他软件。

华硕的联络信息

按下 联络信息 标签页会显示华硕电脑的联络信息。您也可以在本手册的封面内页找到华硕的联络方式。

其他信息

在驱动程序画面的右方有几个图标能提供给您有关于易电脑和驱动程序光盘的其他信息。点击每一个图标会出现弹出的相关内容。



系统信息



技术支持



光盘内容



读我文件

附录

- ◎ 商标声明
- ◎ 外围设备合格供应商列表
- ◎ GNU General Public License

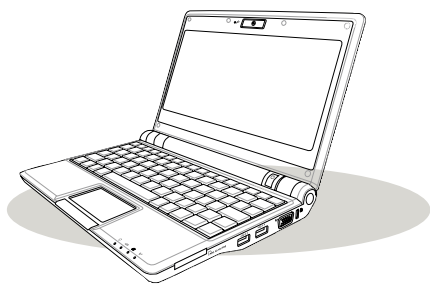

商标声明

在用户手册中所谈论到的产品名称或商标符号仅做识别之用，这些名称可能是属于其他公司的注册商标或是版权，在此声明如下：

- Google Talk 服务与商标是 Google 公司的注册商标
- GroupWise 服务与商标是 Novell 公司的注册商标
- MSN 服务与商标是 Microsoft 公司的注册商标
- QQ 服务与商标是 Tencent 公司的注册商标
- Yahoo! 服务与商标是 Yahoo! 公司的注册商标
- 其他未提到的服务与商标，均属该注册公司所拥有

外围设备合格供应商列表



1. 欢迎您访问华硕网站查看最新的合格供应商列表。
2. 并非所有的外围设备均能在易电脑的 Linux 操作系统上运行，在您购买外围产品时，请先查看最新的合格供应商列表。

类比电视卡	
类型	型号
USB2.0	Leadtek WinFast PalmTop TV
	Upmost Mobile TV 3
蓝牙设备	
类型	型号
USB 1.1	Billionton GUBTCR41A-BT
	Easy RU5AWBC5U
拨接调制解调器	
类型	型号
USB 1.1	Galileo DU-560M
数字家庭设备	
类型	型号
USB 1.1	ASUS Ai Guru S1
数码电视卡	
类型	型号
USB 2.0	Compro U3
	Upmost DVB250
	Upmost AD350
	V-Gear MobiDTV
	Upmost DVB870
直线排线连接设备	
类型	型号
USB 2.0	BELKIN-Transfer cable
显示设备	
类型	型号
D-Sub	Acer AL1916W
	Acer AL2216W
	AOC L154W
	AOC 210V
	AOC 2212PH
	AOC 511VWB
	ASUS PW191
	ASUS PW201
	ASUS MW221U
	ASUS TLW32001D
	BenQ DV2680
	BenQ T905
	BenQ FP22W
	Dell 1907FP

外围设备合格供应商列表

D-Sub	Dell FP2407FWP
	EIZO HD2441W
	Hannsg GF191
	Hannsg HG281D
	Hannsg HW216
	LG L245WP
	LG L1930B
	Philips 150P2
	Philips 170B5
	Philips 190B6
	Philips 32PF7320
	Samsung 740NW
	Samsung 225MS
	Samsung 940B
	Sony KDL-26S2020
	Tatung V22ECBF
	ViewSonic P227F
	ViewSonic VA1716W
	ViewSonic VX2235WM
	ViewSonic VX2435WM
	ViewSonic VX2835WM
	ViewSonic VX912
	ViewSonic N3206W
投影机	Hitachi CP-X253
	Jector PT-XA2
	Premier LX-2200
	Premier PD-X730
	Toshiba TDP-T90
耳机	
类型	型号
耳机	AKG K601
	Audio-technia ATH-AD300
	OZAKI TX079
	Sennheiser PX100
有麦克风的 耳机	Creative HS-300
	Hiawak 03-M58720
	Logitech Precision PC Gaming
	Philips SBC HM450

外围设备合格供应商列表

Fast Ethernet Unmanaged Switch/Hub Adapter	
类型	型号
Home Plug	D-Link-DHP200
	PCI-PLC-85AA
Hub	3com 3C16754
	D-Link DFE908DX
Switch	3com 3C16792A
	ASUS GIGAX1116
	ASUS GIGAX2024
	ASUS GIGAX2124X
	CISCO WS-C2950T24
	D-Link DGS-1005D
	D-Link DGS-1008D
	SMC SMC8505T
	ZyXel GS-105A
Router	Buffalo-BBR-4HG
	Corega CG-BARPS
	D-Link DI-707P
	PCI BRL-04AX
Flash Memory Card Reader/Writer	
类型	型号
USB 2.0	Apacer Card Reader AR020
	Apacer Card Reader AP450
	Digimaster USB-25IN1
	I Rock-All In One
	Kingston Card Reader FCR-MLFE
	Philips
	Powersync CR220W
	Sanwa ADR-MLT17
	TRANSCEND Multi Card Reader M2
软驱	
类型	型号
USB 1.1	Mitsumi D353FUE
	Sony MPF82E
HandWriter Devices	
类型	型号
USB 1.1	PenPower Touch Pad PD8UE

外围设备合格供应商列表

Joystick & Game Pad Devices	
类型	型号
USB 1.1	Logitech Dual Action GamePad
	Logitech Dual Action2
	Logitech Driving Force EX
	Logitech Rumblepad2
	Logitech Extreme 3D Pro-J-UK17
键盘	
类型	型号
USB 1.1	BenQ 6511-ME
	Detroit CT603
	Ergotech ET-K701
	Logitech LX700
	Logitech MX300 Laser
	Logitech New Touch keyboard200
	Logitech YBP62A
	Microsoft Comfort Curve Keyboard200
	Samsung PKB7000X
	Songwin MCK100
	Zippy WK610
M.O. Devices	
类型	型号
USB 1.1	Imation MO1064-UB
USB 2.0	Buffalo MOUZ-P640R
	Fujitsu U2 MO 2.3G
	I-O Data MOA-i640S
麦克风	
类型	型号
Condenser	Hawk MIC989
	Ktnet KTsep111AS
	SonudMAX ARRYA-2S
Dynamic	Audio-technica AT-VD5
Mobile Phone Devices	
类型	型号
USB 1.1	PHS A91
鼠标	
类型	型号
USB 1.1	Acrox MT5
	Genius GM-03003
	INX IM7301

外围设备合格供应商列表

USB 1.1	INX IM7501
	INX IM7701
	Logitech G9 Laser
	Logitech LX-7 Cordless
	Logitech MX1000Laser
	Logitech M-RBH113
	Logitech M-UAE96
	Logitech VAG96B
	Logitech V200 Cordless
	Logitech M-BZ96C
	RaZer Copperhead RZ01
	Microsoft Comfort Optical Mouse 3000
	Microsoft Wireless Optical Desktop
	Microsoft Comfort Optical Mouse
ODD CD/DVD-ROM/CD-RW/Combo/DVD+-RW Devices	
类型	型号
USB 2.0	BENQ-EW164B
	BENQ-EW200G
	BENQ-TW200D
	Lite-On SHM-165P6SX
	Pioneer DVR-X122
	Sony DRX-S70U
	Sony DRX-820UL
	Sony SRX-S50U
	Teac DVW28SLA100
PDA/Cell Phone Devices	
类型	型号
USB 1.1	BENQ P50
打印机	
类型	型号
USB 1.1	Canon i6100
	Epson Stylus Color1160
USB 2.0	Canon PIXMA ip90
	Epson Stylus CX3700
	Epson Stylus PhotoR800
	HP Color Laser Jet 1600
	HP DeskJet D2360
	HP Photosmart D5160
	Lexmark Z818
	Samsung ML2010

外围设备合格供应商列表

USB 2.0	Epson Stylus Photo790
	HP Deskjet 995C
	HP Deskjet 5550
PC Camera Devices	
类型	型号
USB 2.0	Microsoft-VX1000
	Logitech VUAR38
移动硬盘	
类型	型号
	HITEC-HITC25CG
	iPod Video 80G
	NuSLIM NS320C+
	Toponepower TB-35C2
	UCI SA350-T
	Vantec NST-755UF-BK
	Zynet HD-D5-U2FW
Smart Card	
类型	型号
SD	SanDisk Ultrall 2GB
	Transcend TS512MUSD
	Transcend TS2GSDC
	Transcend TS4GSD150
	Kingston SD 512M
	Kingston Mini SD/2GB
	Kingston SD/2GB
	Apacer SD/60x/1G
	Apacer SD/60x/2G
	Kingston Mini SD 4GB
	Kingmax 64MB MMC
MMC	Transcend TS128MRMMC
	Transcend TS1GRMMC4
	Transcend TS512MMCM
	Transcend TS2GMMC4
	Transcend TS4GMMC4
	PQI mobile/1GB
	Kingston SD/1GBFE
SDHC	A-DATA SDHC 4GB
	A-DATA SDHC 8GB
	Kingston SDHC 4GB
	PNY SDHC 4GB

外围设备合格供应商列表

SDHC	PQI SDHC 4GB
	SanDisk SDHC 4GB
	SanDisk ultrall SDHC 4GB
	Toshiba M01GR4W 1GB
	Toshiba M02GR4W 2GB
	Toshiba M04GR4W 4GB
	Toshiba M08GR4W 8GB
	Transcend TS4GSDHC6
	Transcend TS8GSDHC6
外接音响设备	
类型	型号
Line out	Altec Lansing 5100
	Altec Lansing VS-2120
	JS JY5000
	Logitech S100
	Ozaki NU926
USB 1.1	Yamaha YST-MS35D
	Logitech V10
扫描仪	
类型	型号
USB 1.1	Epson Perfection 1650 Photo
USB 2.0	Canon CanoScan LiDE30
	Epson Stylus CX3700
	Epson Perfection 4990 Photo
Sound Adapters	
类型	型号
USB 2.0	Mediatek Audimax F1
U 盘	
类型	型号
USB 2.0	Adata MyFlash
	Adata PD10
	Apacer HA202 2G Flash
	Apacer AH221
	Apacer AH320
	ASUS Ai-FLASH V
	Kingston DTR
	PQI U172P
	PQI U230
	Sandisk SDCZ6
	TRANSCEND JetFlash V10

外围设备合格供应商列表

USB 2.0	Transcend JetFlash V20
	Transcend JF168
USB HUB Devices	
类型	型号
USB 2.0	ELECOM U2H-MN4BBU
	SANWA-206W
Wireless Lan Access Point	
类型	型号
AP	ASUS WL-500W
	ASUS WL-320GP
	Buffalo WHR-G54S
	Corega-CG WLBARAG2
	D-Link DI-624
	D-Link DIR-635
	D-Link DIR-655
	Linksys WRT54G
	Netgear WPN824
	SMC SMCWBR14-N
	Zyxel NBG-415N
	Corega CG-WLBARGLV2
	Corega CG-WLBARGNR
	Pci GW-AP54P
	Pci BLW-HPMM-U
	Pci MZK-W04N
	Zyxel P-330W
	Zyxel P-336M
	SMC WBR11-G
	SMC SMCWBR14T-G2
	D-Link DWL-G700AP
	D-LinkDGL-4300
	D-LinkDIR-451
	D-LinkDIR-300
	D-LinkDIR-615
	D-LinkDI-624S
	Zyxel P-334SH
	Zyxel P-320W
	Corega CG-WLNSC1000
	PCI BLW-54MF
	PCI BLW-54MR
	Buffalo WHR-HP-G54

外围设备合格供应商列表

AP	Lemel LM-WLG6400
	Belkin F5D9230-4
Wireless Ethernet Adapters	
类型	型号
USB 2.0	ASUS WL-167G
	PCI GW-US300MiniW
3G WLAN Adapter	
类型	型号
USB	ASUS T500
	Amoi H01
	HUAWEI E220
	PAH A91
3G Telecommunications	
地区	电信业者
Taiwan	Chunghwa Telecom
	Far EasTone
	PHS
	Taiwan Cellular
100 BaseTx Ethernet Adapters	
类型	型号
USB 2.0	Billionton USB2AR2

GNU General Public License

Licensing Information

This product includes copyrighted third-party software licensed under the terms of the GNU General Public License. See The GNU General Public License for the exact terms and conditions of this license. Specially, the following parts of this product are subject to the GNU GPL:

- The Linux operating system kernel
- Firefox
- Kworldclock
- Pidgin
- KCal
- Kontact
- KSnapshot
- Thunderbird
- Knotes
- Kalzium
- Kstars
- Tux Typing
- KMessedWords
- KHangMan
- Kbruch
- Freemind
- Stellarium
- Tux, of Math Command
- Kig
- KmPlot
- mtPaint
- Tux Paint
- KPatience
- Frozen Bubble
- Crack Attack
- GNOME Sudoku
- KTuberling
- LTris
- The KControl Xprinters Module
- The KControl Clock Module
- GSynaptics
- Gcompris
- Enigma
- Supertux
- Boswars
- Xmahjongg
- Tuxpuck

All listed software packages are copyright by their respective authors. Refer to the source code for detailed information.

ASUSTeK COMPUTER Inc. has exposed the full source code of the GPL licensed software, including any scripts to control compilation and installation of the object code. All future firmware updates will also be accompanied with their respective source code. For more information on how you can obtain our open source code, visit our website (<http://support.asus.com.tw/download/>).

GNU GENERAL PUBLIC LICENSE

Version 2, June 1991

Copyright (C) 1989, 1991 Free Software Foundation, Inc.,
51 Franklin Street, Fifth Floor, Boston, MA 02110-1301 USA

Everyone is permitted to copy and distribute verbatim copies
of this license document, but changing it is not allowed.

Preamble

The licenses for most software are designed to take away your freedom to share and change it. By contrast, the GNU General Public License is intended to guarantee your freedom to share and change free software--to make sure the software is free for all its users. This General Public License applies to most of the Free Software Foundation's software and to any other program whose authors commit to using it. (Some other Free Software Foundation software is covered by the GNU Lesser General Public License instead.) You can apply it to your programs, too.

When we speak of free software, we are referring to freedom, not price. Our General Public Licenses are designed to make sure that you have the freedom to distribute copies of free software (and charge for this service if you wish), that you receive source code or can get it if you want it, that you can change the software or use pieces of it in new free programs; and that you know you can do these things.

To protect your rights, we need to make restrictions that forbid anyone to deny you these rights or to ask you to surrender the rights. These restrictions translate to certain responsibilities for you if you distribute copies of the software, or if you modify it.

For example, if you distribute copies of such a program, whether gratis or for a fee, you must give the recipients all the rights that you have. You must make sure that they, too, receive or can get the source code. And you must show them these terms so they know their rights.

We protect your rights with two steps: (1) copyright the software, and (2) offer you this license which gives you legal permission to copy, distribute and/or modify the software.

Also, for each author's protection and ours, we want to make certain that everyone understands that there is no warranty for this free software. If the software is modified by someone else and passed on, we want its recipients to know that what they have is not the original, so that any problems introduced by others will not reflect on the original authors' reputations.

Finally, any free program is threatened constantly by software patents. We wish to avoid the danger that redistributors of a free program will individually obtain patent licenses, in effect making the program proprietary. To prevent this, we have made it clear that any patent must be licensed for everyone's free use or not licensed at all.

The precise terms and conditions for copying, distribution and modification follow.

TERMS AND CONDITIONS FOR COPYING, DISTRIBUTION AND MODIFICATION

0. This License applies to any program or other work which contains a notice placed by the copyright holder saying it may be distributed under the terms of this General Public License. The "Program", below, refers to any such program or work, and a "work based on the Program" means either the Program or any derivative work under copyright law: that is to say, a work containing the Program or a portion of it, either verbatim or with modifications and/or translated into another language. (Hereinafter, translation is included without limitation in the term "modification".) Each licensee is addressed as "you".

Activities other than copying, distribution and modification are not covered by this License; they are outside its scope. The act of running the Program is not restricted, and the output from the Program is covered only if its contents constitute a work based on the Program (independent of having been made by running the Program). Whether that is true depends on what the Program does.

1. You may copy and distribute verbatim copies of the Program's source code as you receive it, in any medium, provided that you conspicuously and appropriately publish on each copy an appropriate copyright notice and disclaimer of warranty; keep intact all the notices that refer to this License and to the absence of any warranty; and give any other recipients of the Program a copy of this License along with the Program.

You may charge a fee for the physical act of transferring a copy, and you may at your option offer warranty protection in exchange for a fee.

2. You may modify your copy or copies of the Program or any portion of it, thus forming a work based on the Program, and copy and distribute such modifications or work under the terms of Section 1 above, provided that you also meet all of these conditions:

- a) You must cause the modified files to carry prominent notices stating that you changed the files and the date of any change.
- b) You must cause any work that you distribute or publish, that in whole or in part contains or is derived from the Program or any part thereof, to be licensed as a whole at no charge to all third parties under the terms of this License.
- c) If the modified program normally reads commands interactively when run, you must cause it, when started running for such interactive use in the most ordinary way, to print or display an announcement including an appropriate copyright notice and a notice that there is no warranty (or else, saying that you provide a warranty) and that users may redistribute the program under these conditions, and telling the user how to view a copy of this License. (Exception: if the Program itself is interactive but does not normally print such an announcement, your work based on the Program is not required to print an announcement.)

These requirements apply to the modified work as a whole. If identifiable sections of that work are not derived from the Program, and can be reasonably considered independent and separate works in themselves, then this License, and its terms, do not apply to those sections when you distribute them as separate works. But when you distribute the same sections as part of a whole which is a work based on the Program, the distribution of the whole must be on the terms of this License, whose permissions for other licensees extend to the entire whole, and thus to each and every part regardless of who wrote it.

Thus, it is not the intent of this section to claim rights or contest your rights to work written entirely by you; rather, the intent is to exercise the right to control the distribution of derivative or collective works based on the Program.

In addition, mere aggregation of another work not based on the Program with the Program (or with a work based on the Program) on a volume of a storage or distribution medium does not bring the other work under the scope of this License.

3. You may copy and distribute the Program (or a work based on it, under Section 2) in object code or executable form under the terms of Sections 1 and 2 above provided that you also do one of the following:

- a) Accompany it with the complete corresponding machine-readable source code, which must be distributed under the terms of Sections 1 and 2 above on a medium customarily used for software interchange; or,
- b) Accompany it with a written offer, valid for at least three years, to give any third party, for a charge no more than your cost of physically performing source distribution, a complete machine-readable copy of the corresponding source code, to be distributed under the terms of Sections 1 and 2 above on a medium customarily used for software interchange; or,

c) Accompany it with the information you received as to the offer to distribute corresponding source code. (This alternative is allowed only for noncommercial distribution and only if you received the program in object code or executable form with such an offer, in accord with Subsection b above.)

The source code for a work means the preferred form of the work for making modifications to it. For an executable work, complete source code means all the source code for all modules it contains, plus any associated interface definition files, plus the scripts used to control compilation and installation of the executable. However, as a special exception, the source code distributed need not include anything that is normally distributed (in either source or binary form) with the major components (compiler, kernel, and so on) of the operating system on which the executable runs, unless that component itself accompanies the executable.

If distribution of executable or object code is made by offering access to copy from a designated place, then offering equivalent access to copy the source code from the same place counts as distribution of the source code, even though third parties are not compelled to copy the source along with the object code.

4. You may not copy, modify, sublicense, or distribute the Program except as expressly provided under this License. Any attempt otherwise to copy, modify, sublicense or distribute the Program is void, and will automatically terminate your rights under this License. However, parties who have received copies, or rights, from you under this License will not have their licenses terminated so long as such parties remain in full compliance.

5. You are not required to accept this License, since you have not signed it. However, nothing else grants you permission to modify or distribute the Program or its derivative works. These actions are prohibited by law if you do not accept this License. Therefore, by modifying or distributing the Program (or any work based on the Program), you indicate your acceptance of this License to do so, and all its terms and conditions for copying, distributing or modifying the Program or works based on it.

6. Each time you redistribute the Program (or any work based on the Program), the recipient automatically receives a license from the original licensor to copy, distribute or modify the Program subject to these terms and conditions. You may not impose any further restrictions on the recipients' exercise of the rights granted herein. You are not responsible for enforcing compliance by third parties to this License.

7. If, as a consequence of a court judgment or allegation of patent infringement or for any other reason (not limited to patent issues), conditions are imposed on you (whether by court order, agreement or otherwise) that contradict the conditions of this License, they do not excuse you from the conditions of this License. If you cannot distribute so as to satisfy simultaneously your obligations under this License and any other pertinent obligations, then as a consequence you may not distribute the Program at all. For example, if a patent license would not permit royalty-free redistribution of the Program by all those who receive copies directly or indirectly through you, then the only way you could satisfy both it and this License would be to refrain entirely from distribution of the Program.

If any portion of this section is held invalid or unenforceable under any particular circumstance, the balance of the section is intended to apply and the section as a whole is intended to apply in other circumstances.

It is not the purpose of this section to induce you to infringe any patents or other property right claims or to contest validity of any such claims; this section has the sole purpose of protecting the integrity of the free software distribution system, which is implemented by public license practices. Many people have made generous contributions to the wide range of software distributed through that system in reliance on consistent application of that system; it is up to the author/donor to decide if he or she is willing to distribute software through any other system and a licensee cannot impose that choice.

This section is intended to make thoroughly clear what is believed to be a consequence of the rest of this License.

8. If the distribution and/or use of the Program is restricted in certain countries either by patents or by copyrighted interfaces, the original copyright holder who places the Program under this License may add an explicit geographical distribution limitation excluding those countries, so that distribution is permitted only in or among countries not thus excluded. In such case, this License incorporates the limitation as if written in the body of this License.

9. The Free Software Foundation may publish revised and/or new versions of the General Public License from time to time. Such new versions will be similar in spirit to the present version, but may differ in detail to address new problems or concerns.

Each version is given a distinguishing version number. If the Program specifies a version number of this License which applies to it and "any later version", you have the option of following the terms and conditions either of that version or of any later version published by the Free Software Foundation. If the Program does not specify a version number of this License, you may choose any version ever published by the Free Software Foundation.

10. If you wish to incorporate parts of the Program into other free programs whose distribution conditions are different, write to the author to ask for permission. For software which is copyrighted by the Free Software Foundation, write to the Free Software Foundation; we sometimes make exceptions for this. Our decision will be guided by the two goals of preserving the free status of all derivatives of our free software and of promoting the sharing and reuse of software generally.

NO WARRANTY

11. BECAUSE THE PROGRAM IS LICENSED FREE OF CHARGE, THERE IS NO WARRANTY FOR THE PROGRAM, TO THE EXTENT PERMITTED BY APPLICABLE LAW. EXCEPT WHEN OTHERWISE STATED IN WRITING THE COPYRIGHT HOLDERS AND/OR OTHER PARTIES PROVIDE THE PROGRAM "AS IS" WITHOUT WARRANTY OF ANY KIND, EITHER EXPRESSED OR IMPLIED, INCLUDING, BUT NOT LIMITED TO, THE IMPLIED WARRANTIES OF MERCHANTABILITY AND FITNESS FOR A PARTICULAR PURPOSE. THE ENTIRE RISK AS TO THE QUALITY AND PERFORMANCE OF THE PROGRAM IS WITH YOU. SHOULD THE PROGRAM PROVE DEFECTIVE, YOU ASSUME THE COST OF ALL NECESSARY SERVICING, REPAIR OR CORRECTION.

12. IN NO EVENT UNLESS REQUIRED BY APPLICABLE LAW OR AGREED TO IN WRITING WILL ANY COPYRIGHT HOLDER, OR ANY OTHER PARTY WHO MAY MODIFY AND/OR REDISTRIBUTE THE PROGRAM AS PERMITTED ABOVE, BE LIABLE TO YOU FOR DAMAGES, INCLUDING ANY GENERAL, SPECIAL, INCIDENTAL OR CONSEQUENTIAL DAMAGES ARISING OUT OF THE USE OR INABILITY TO USE THE PROGRAM (INCLUDING BUT NOT LIMITED TO LOSS OF DATA OR DATA BEING RENDERED INACCURATE OR LOSSES SUSTAINED BY YOU OR THIRD PARTIES OR A FAILURE OF THE PROGRAM TO OPERATE WITH ANY OTHER PROGRAMS), EVEN IF SUCH HOLDER OR OTHER PARTY HAS BEEN ADVISED OF THE POSSIBILITY OF SUCH DAMAGES.

END OF TERMS AND CONDITIONS

How to Apply These Terms to Your New Programs

If you develop a new program, and you want it to be of the greatest possible use to the public, the best way to achieve this is to make it free software which everyone can redistribute and change under these terms.

To do so, attach the following notices to the program. It is safest to attach them to the start of each source file to most effectively convey the exclusion of warranty; and each file should have at least the "copyright" line and a pointer to where the full notice is found.

<one line to give the program's name and a brief idea of what it does.> Copyright (C) <year> <name of author>

This program is free software; you can redistribute it and/or modify it under the terms of the GNU General Public License as published by the Free Software Foundation; either version 2 of the License, or (at your option) any later version.

This program is distributed in the hope that it will be useful, but WITHOUT ANY WARRANTY; without even the implied warranty of MERCHANTABILITY or FITNESS FOR A PARTICULAR PURPOSE. See the GNU General Public License for more details.

You should have received a copy of the GNU General Public License along with this program; if not, write to the Free Software Foundation, Inc., 51 Franklin Street, Fifth Floor, Boston, MA 02110-1301 USA.

Also add information on how to contact you by electronic and paper mail.

If the program is interactive, make it output a short notice like this when it starts in an interactive mode:

Gnomovision version 69, Copyright (C) year name of author
Gnomovision comes with ABSOLUTELY NO WARRANTY; for details
type `show w'. This is free software, and you are welcome to
redistribute it under certain conditions; type `show c' for details.

The hypothetical commands ``show w'` and ``show c'` should show the appropriate parts of the General Public License. Of course, the commands you use may be called something other than ``show w'` and ``show c'`; they could even be mouse-clicks or menu items--whatever suits your program.

You should also get your employer (if you work as a programmer) or your school, if any, to sign a "copyright disclaimer" for the program, if necessary. Here is a sample; alter the names:

Yoyodyne, Inc., hereby disclaims all copyright interest in the program ``Gnomovision'` (which makes passes at compilers) written by James Hacker.

<signature of Ty Coon>, 1 April 1989

Ty Coon, President of Vice

This General Public License does not permit incorporating your program into proprietary programs. If your program is a subroutine library, you may consider it more useful to permit linking proprietary applications with the library. If this is what you want to do, use the GNU Lesser General Public License instead of this License.

Declarations and Safety Statements

Federal Communications Commission Statement

This device complies with FCC Rules Part 15. Operation is subject to the following two conditions:

- This device may not cause harmful interference, and
- This device must accept any interference received, including interference that may cause undesired operation.

This equipment has been tested and found to comply with the limits for a class B digital device, pursuant to Part 15 of the Federal Communications Commission (FCC) rules. These limits are designed to provide reasonable protection against harmful interference in a residential installation. This equipment generates, uses, and can radiate radio frequency energy and, if not installed and used in accordance with the instructions, may cause harmful interference to radio communications. However, there is no guarantee that interference will not occur in a particular installation. If this equipment does cause harmful interference to radio or television reception, which can be determined by turning the equipment off and on, the user is encouraged to try to correct the interference by one or more of the following measures:

- Reorient or relocate the receiving antenna.
- Increase the separation between the equipment and receiver.
- Connect the equipment into an outlet on a circuit different from that to which the receiver is connected.
- Consult the dealer or an experienced radio/TV technician for help.



The use of a shielded-type power cord is required in order to meet FCC emission limits and to prevent interference to the nearby radio and television reception. It is essential that only the supplied power cord be used. Use only shielded cables to connect I/O devices to this equipment. You are cautioned that changes or modifications not expressly approved by the party responsible for compliance could void your authority to operate the equipment.

(Reprinted from the Code of Federal Regulations #47, part 15.193, 1993.
Washington DC: Office of the Federal Register, National Archives and Records
Administration, U.S. Government Printing Office.)

FCC Radio Frequency (RF) Exposure Caution Statement



Any changes or modifications not expressly approved by the party responsible for compliance could void the user's authority to operate this equipment. "The manufacture declares that this device is limited to Channels 1 through 11 in the 2.4GHz frequency by specified firmware controlled in the USA."

This equipment complies with FCC radiation exposure limits set forth for an uncontrolled environment. To maintain compliance with FCC RF exposure compliance requirements, please avoid direct contact to the transmitting antenna during transmitting. End users must follow the specific operating instructions for satisfying RF exposure compliance.

Max. SAR Measurement (1g)

802.11b SAR Value: 0.033 W/kg

802.11g SAR Value: 0.055 W/kg

技术支持与服务

若您需要任何技术支持与服务，请访问华硕互联网

<http://support.asus.com.cn>